

This is copied by me from the Original Survey (in my possession)
of P. Williams under the direction of the Commissioners appointed by
an act of Assembly for the purpose of selling the Bristow tract ^{map} and the
20th Feb 1723 (See also page 86 - ch. 64) - The survey was transmitted by
the Legislature of 1723-4. It is dated by Mr. Williams the
11th June 1723. The report of the Comrs is not to be found in the
House of Delegates nor in the Committee room -

Richard D. Sept 1829

J. Brown Jr
2d Auditor

The Commissioners were
Hansel, Gorman
Walter Harrison
Walter Peyton

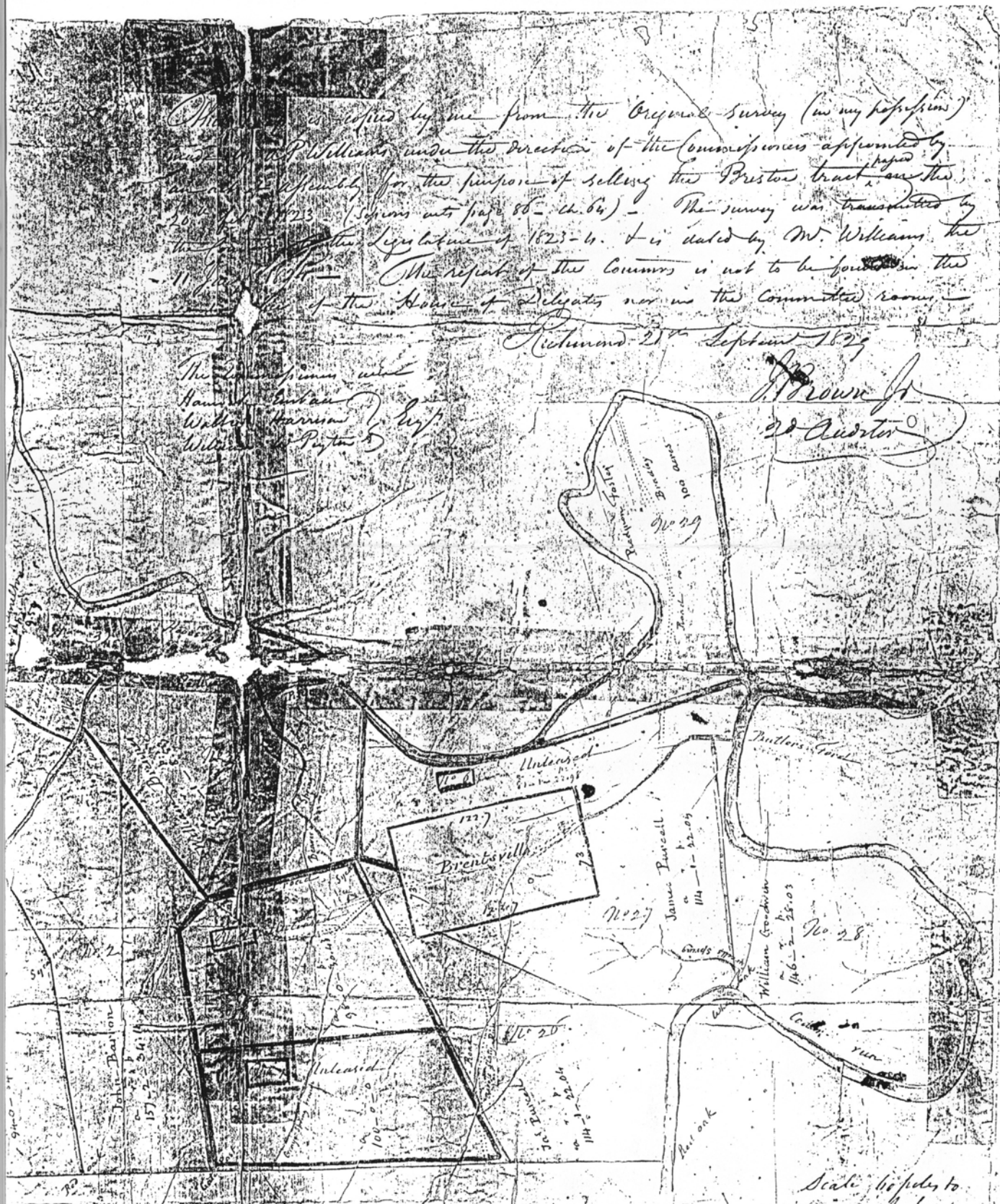

Scale 1/2 pole to
one Inch

WITH THIS MAP
PG.

2 A 45

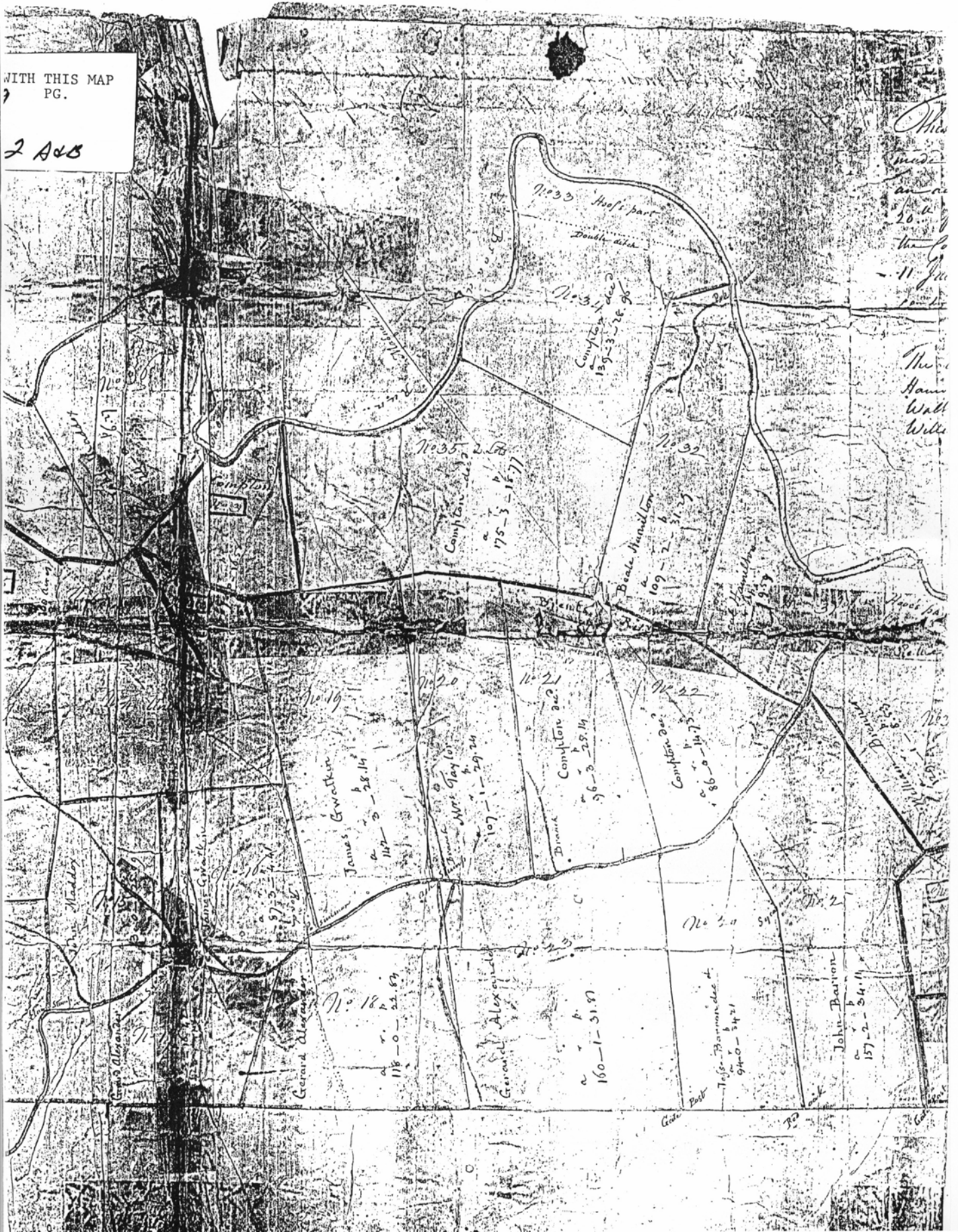

*Miss
Med
an ac
20.6
the Co
- 11. J
part*

*The
Ham
Wall
Wille*

*No. 30
136.7*

*No. 33
Hoff's part
Double area*

*No. 31
139-3-26.90*

*No. 35
2.28
Completion dec. 175-3-16.77*

No. 30

*Beale Hamilton
109-2-6.17*

*E. Hamilton
1937*

No. 19

No. 20

No. 21

No. 22

*James Gwathkin
112-3-28.14*

*Mrs. Taylor
107-1-29.24*

*Dr. Brand
Completion dec. 106-3-28.14*

Completion dec. 106-0-14.75

*No. 18
118-0-31.87*

*Gerard Alexander
160-1-31.87*

No. 24

No. 21

*John Barton
157-2-34.11*

*768-33
94-0-34.21*

James Allison

Gerard Alexander

John Barton

Civil Post

10

