



**VIRGINIA
HISTORIC LANDMARKS COMMISSION**

File no. 76-284
Negative no(s). No Photos

SURVEY FORM

Historic name Bailey House (site)	Common name AKA Terrapin Forest, Callender House
County/Town/City Prince William County	
Street address or route number vic. 16311 Dumfries Road	
USGS Quad Quantico Quad.	Date or period late 18th century plantation
Original owner Arrington Wickliffe?	Architect/builder/craftsman
Original use Residence	
Present owner Cecil D. Hylton	Source of name 19th century owners
Present owner address 13901 Jeff Davis Highway	Source of date WPA history
Woodbridge, Va. 22191	Stories N/A
Present use Not in use	Foundation and wall const'n N/A
Acreage c 306 acres	Roof type N/A
State condition of structure and environs No trace of Bailey House found, only the ruins of an early 20th century house or barn.	
State potential threats to structure Development	
Note any archaeological interest This would be an archeological site--mid-to-late 18th century tide-water plantation site, family burial ground, possible Hessian graveyard, War of 1812 lookout station.	
Should be investigated for possible register potential? yes ___ no ___	
Architectural description (Note significant features of plan, structural system and interior and exterior decoration, taking care to point out aspects not visible or clear from photographs. Explain nature and period of all alterations and additions. List any outbuildings and their approximate ages, cemeteries, etc.)	
<p>The Bailey place is located on the east side of S.R. 234, 1/3 mile th of Mt. Zion Church and across from a portion of the Prince William Forest Park. To the north of the property is Montclair residential subdivision. A power line bisects the property, which totals about 306 acres and is owned by Prince William County developer C.D. Hylton. The traditional boundaries of the property (the larger area historically known as Terrapin Forest) are Powell's Creek on the north and Quantico Creek on the south. I-95 now apparently defines the property's east boundary, and the Montclair subdivision is the northwest boundary. A portion of Terrapin Forest is now contained within the jurisdiction of the Federally-owned Prince William Forest Park.</p> <p>Surveyor visited the property, hoping to find the remains of the Bailey House, which was the manor house, the Eastman-Callender cemetery, and the alleged Hessian graveyard, all of which were mentioned by Susan R. Morton, whose research was published in 1941 in the WPA guide, <u>Prince William, The Story of Its People and Its Places</u>. In 1941, the house was described as a "tottering... weather-beaten frame structure [spread] out low on a U-plan beneath a vast oak." There was a porch filling in the U, and at each end a stone exterior chimney. A log kitchen wing was said to have existed. The Callender-Eastman graveyard was west of the house. Surveyor was unable to find the house described, or the cemetery, though in the vicinity of the USGS benchmark on the property, about a mile from the road was a collapsing, early 20th century frame barn or residence. The graves of the Hessian soldiers mentioned in some of Morton's unpublished notes, were not found. That cemetery could instead be located somewhere in the present Montclair subdivision, as the precise location of the Hessian prisoner camp south of Powell's Creek is not known.</p>	
Interior inspected? N/A	
Historical significance (Chain of title; individuals, families, events, etc., associated with the property.)	
<p>The Bailey Plantation, so-called because, as a farm, the property was last owned by the Bailey family, consisted of parts of two tracts, a 65-acre parcel and a 114-acre parcel. According to the WPA guide, part of the land had been patented by William Champe in 1712, and part in 1724 by John Calvert and Jacob Gibson. The 65-acre tract descended from John Calvert to William Calvert. William Calvert purchased the 114-acre tract from Robert Key, who had bought it from William Champe. In 1796, Arrington Wickliffe bought the estate from William Calvert. In 1799, the heirs of William Carr became owners of the estate, then known as Terrapin Forest. William Carr's daughter, Betsy Carr, was married to Willoughby Tebbs and lived at the now-demolished Tebbsdale. The property was owned in the early to mid-19th century by the Callender family, some of whom intermarried with Eastmans. In the family burial ground (which this surveyor could not find) are the graves of Eastmans and Callenders. In the middle of the 19th century, the estate was owned by the Baileys.</p> <p>Susan R. Morton, the historian for the WPA writers project in Prince William, describes a cemetery, supposedly on the Bailey estate, that local residents believed contained about a dozen graves of Hessian soldiers who had been captured after the battles of Trenton and Saratoga, and were brought to the Dumfries area as prisoners. Put to work constructing buildings in Dumfries, some of the Hessian prisoners were said to have died of typhoid or yellow fever. The camp was on the south side of Powell's Creek.</p>	
(continued next page.)	

Sources and bibliography

Published sources (Books, articles, etc., with bibliographic data.)

WPA, Writers Program, Prince William, The Story of Its People and Its Places (c1941), pp.100-101.

Primary sources (Manuscript documentary or graphic materials: give location.)

Susan R. Morton's unpublished notes for WPA guide.

Names and addresses of persons interviewed E. R. Conner, III, Manassas Museum

Plan (Indicate locations of rooms, doorways, windows, alterations, etc.)

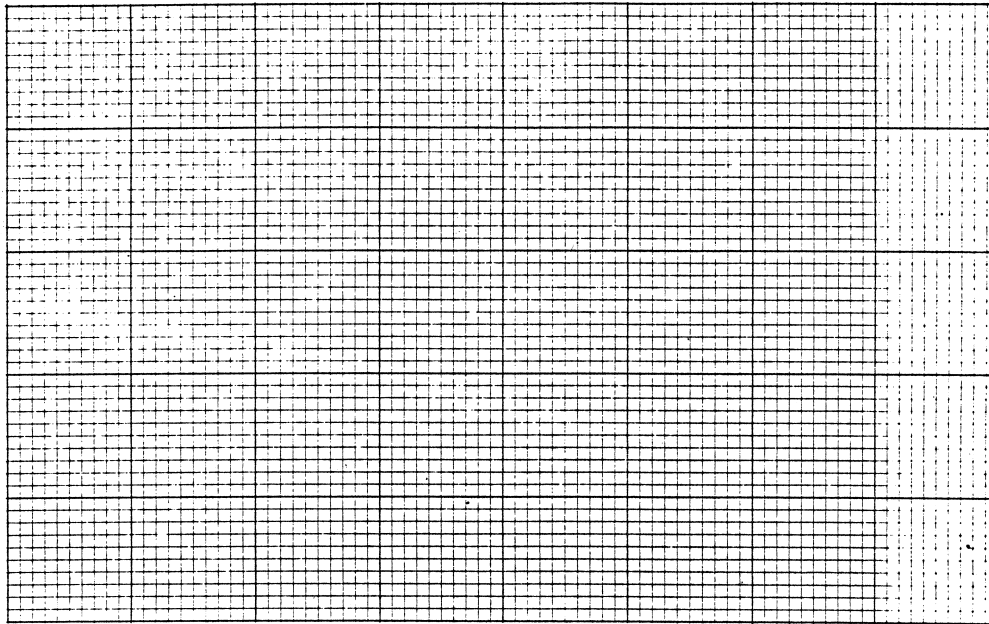

Site plan (Locate and identify outbuildings, dependencies and significant topographical features.)

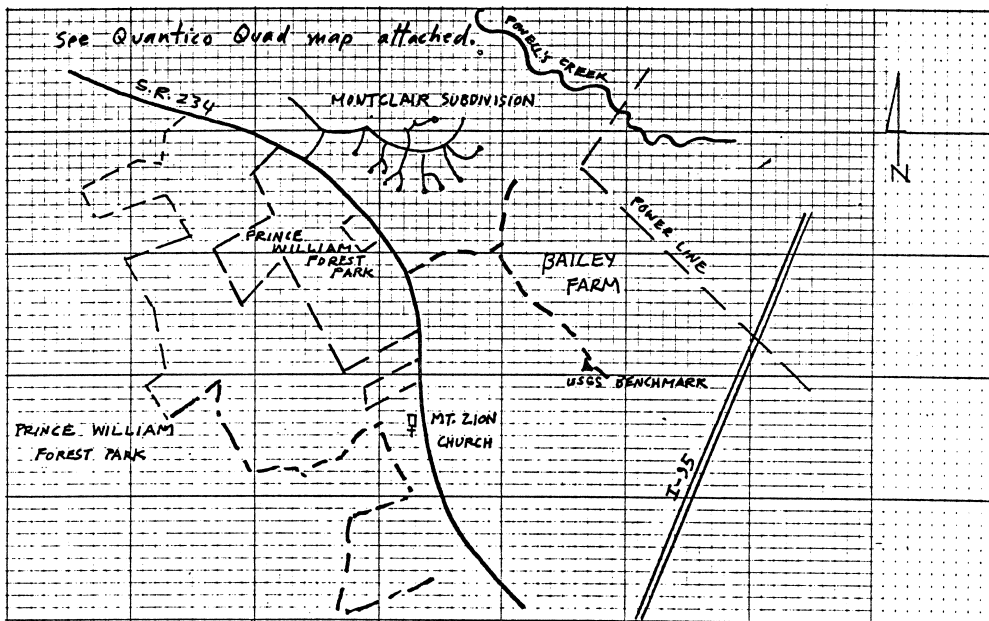

Name, address and title of recorder
James J. [unclear], Architectural
Historical Surveyor, NVDIC

Date
DEC 1980

CONTINUATION SHEET
BAILEY HOUSE (site)

Historical Significance (continued)

During the War of 1812, the higher elevations on the estate were used as lookout points.

The north boundary of Terrapin Forest, historically located between Powell's and Quantico creeks, was the south boundary of Leesylvania, the Henry Lee estate on Freestone Point.

UNITED STATES
DEPARTMENT OF THE INTERIOR
GEOLOGICAL SURVEY

QUANTICO QUAD.

BAILEY HOUSE SITE
76-284

