



VIRGINIA
DIVISION OF HISTORIC LANDMARKS
HISTORIC DISTRICT/BRIEF
SURVEY FORM

File no. 76-338
 Negative no(s). 9674-12, 15

City/Town/Village/Hamlet **Brentsville**
 Street address or route number **12224 Bristow Road**
 Historic name _____

County **Prince William County**
 U.S.G.S. Quad **Nokesville**
 Common name _____

Present use **Residence**
 Original use **Residence**

Building Style **Vernacular**
 Building Date(s) **1890-1920**

1. Construction Materials

- wood frame
- brick
- bond: English
- Flemish
- _____-course American
- stretcher
- other _____
- stone
 - random rubble
 - coursed rubble
 - ashlar dressed
 - rock-faced
- log:
 - squared unsquared
 - notching:
 - V-notch half dovetail
 - saddle full dovetail
 - square diamond
- concrete block
- terra cotta
- steel frame
- other _____

3. Stories (number) 2
 low basement raised basement

4. Bays (number): front 2 side (church) _____
 symmetrical asymmetrical

5. Roof Type
 shed hipped
 parapet? pyramidal?
 gable mansard
 pediment? false mansard
 parapet? gambrel
 clipped end? flat
 cross gable? parapet?
 central front gable? roof not visible
 other _____

6. Roofing Material

- shingle
 - composition (asphalt, asbestos, etc.)
 - wood
 - metal
 - standing seam
 - corrugated
 - pressed tin (simulated shingles)
- tile
 - pantile flat glazed
- slate
- not visible

7. Dormers (number): front _____ side _____
 gable pediment?
 shed
 hipped

8. Primary Porch

style **Vernacular**
 stories 1
 levels 1 bays 3
 materials wood

description and decorative details
Hipped roof, turned posts; entrance has been changed to the side; screened in.

9. General supplementary description and decoration:

2/2 sash; boxed cornice; east end bay.

10. Major additions and alterations: **Asbestos shingles added; plastic shutters added; rear 2-story ell; rear 1-story side porch (closed in).**

PHOTO

- steel frame
- other _____

2. Cladding Material

- weatherboard
- vertical siding
- board & batten
- shingle:
 - wood
 - asbestos
 - asphalt
- bricktex
- other _____
- composition siding
- stucco
- aluminum or vinyl siding
- cast iron
- sheet metal
- enameled metal
- glass

- metal
 - standing seam
 - corrugated
 - pressed tin (simulated shingles)
- tile
 - pantile
 - flat
- slate
- not visible
- glazed

7. Dormers (number): front _____ side _____
 gable pediment?
 shed
 hipped

8. Primary Porch style Vernacular
 stories 1
 levels 1 bays 3
 materials wood
 description and decorative details
Hipped roof, turned posts; entrance has been changed to the side; screened in.

9. General supplementary description and decoration:
2/2 sash; boxed cornice; east end bay.

10. Major additions and alterations: Asbestos shingles added; plastic shutters added; rear 2-story ell; rear 1-story side porch (closed in).

11. Outbuildings: Washhouse, garage, small barn, workshop, and hen house.

12. Landscape Features:
Mature trees and shrubs. Chain link fence.

13. Significance:
Turn-of-the-century dwelling.. One of several in the settlement of Brentsville.

Surveyed by: Frazier Date: May 1989

PHOTO

Primary Sources

Interviews

Name **A.V. Eanes**
 Address **12224 Bristow Rd.
 Bristow, Va. 22013**
 Phone **(703) 368-5166**
 Date _____
 Name _____
 Address _____
 Phone _____
 Date _____

Published Sources

Plan and Massing (Note original features, additions, and alterations)

Drawing of Plan

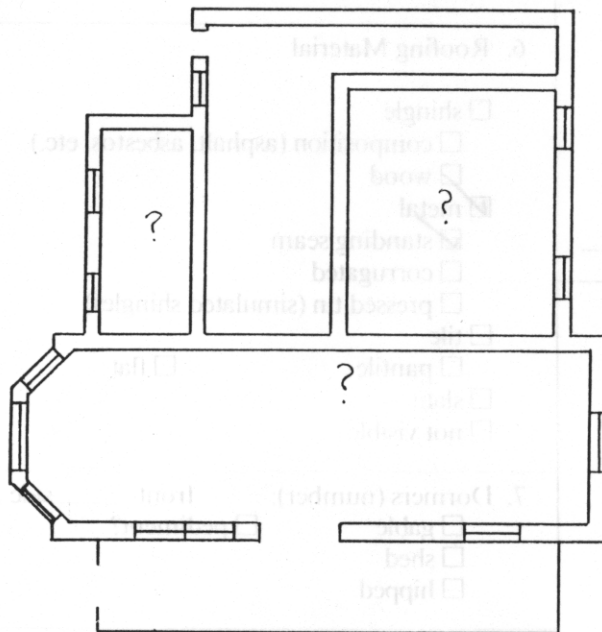

Sketch of Site Plan

BRISTOW ROAD

Historical Information

Jesse Whitzel- previous owner.
1959- present owner purchased from Whitzels.

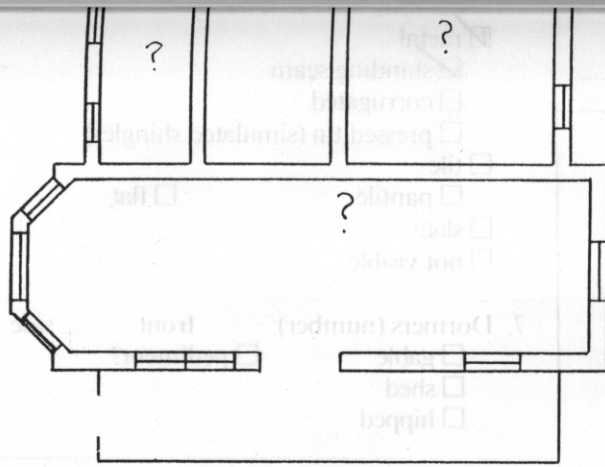

- steel frame
- other
- Cabing Material**
- weatherboard
- vertical siding
- board & batten
- shingle
- wood
- asbestos
- asphalt
- brick
- other
- composition siding
- stucco
- aluminum or vinyl siding
- cast iron
- sheet metal
- enameled metal
- glass

Sketch of Site Plan

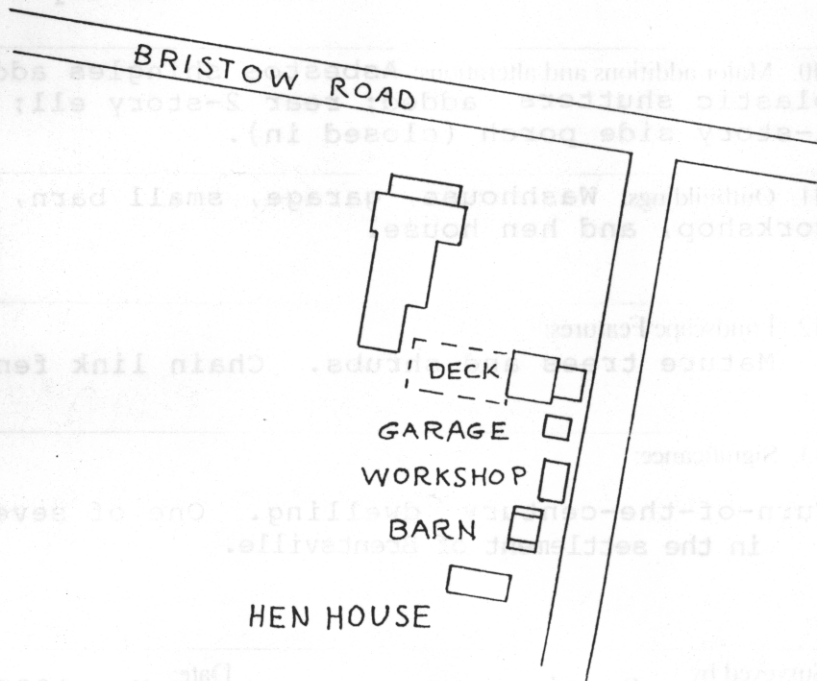

Historical Information

Jesse Whitzel- previous owner.
 1959- present owner purchased from Whitzels.