

5-12-80

# Pentecostal (Main) Church Brentsville

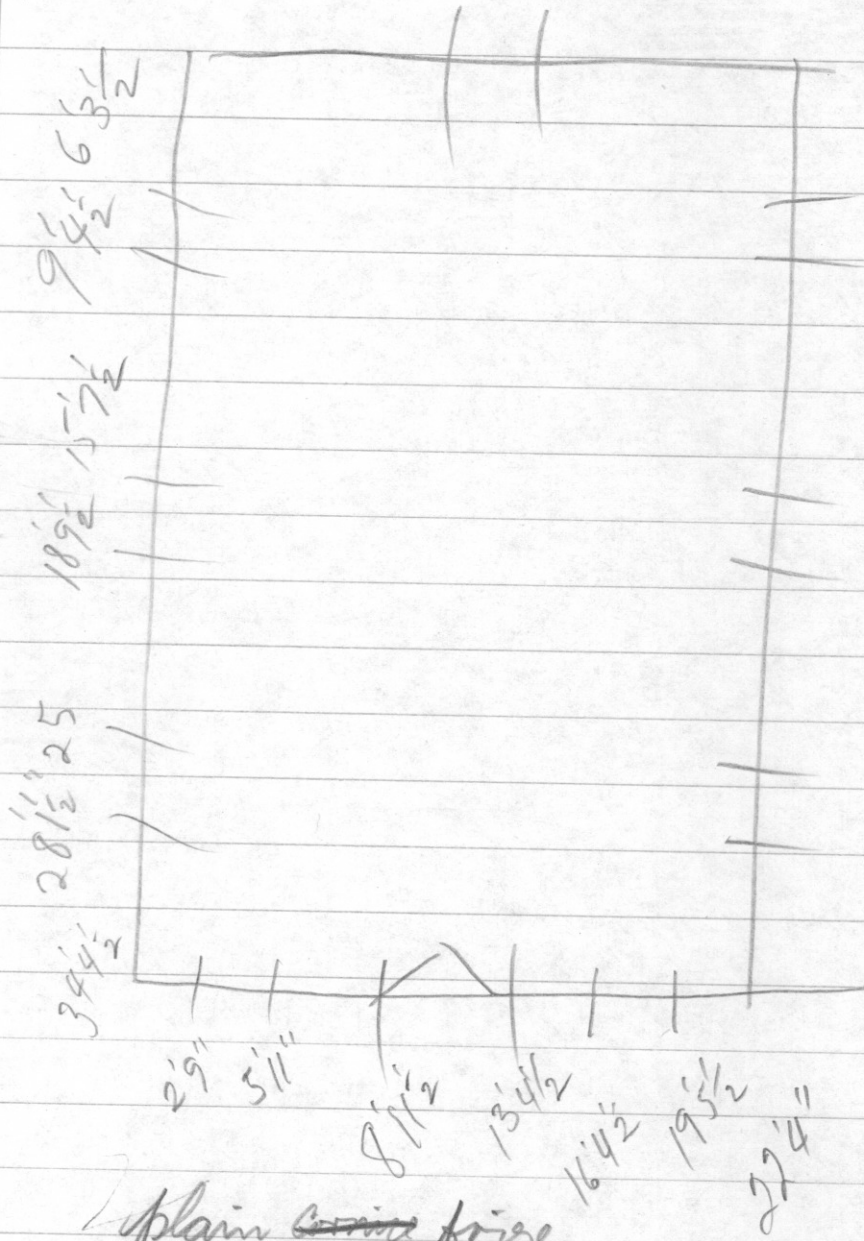

wide cornices w/ 3/4 round  
moulding.  
5 1/2 inch lap weatherboards  
windows 2/2 shuttered  
painted white w/ green shutter  
plain wide box trim with moulded  
hooks on scroll brackets

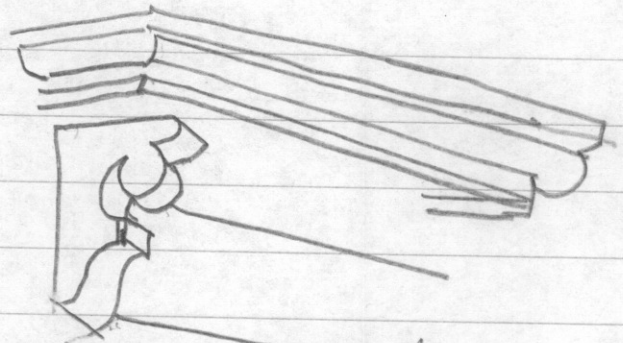

2 panels per door;  
double front door w/ semi-  
circular upper moulded  
panels

3-pane overhead.  
door has barked "hood" lintel.

plain cornice frieze  
gable cuts.  
plain soffits. Simple  
moulded cornice.

stone found.  
belfry.

no cellar.

windows 4/4 sash \*

mortise locks, metal knob + face plate

interior:

pine floors rather wide tongue + groove boards  
painted blue green with brown trim.  
Electrically lighted.

4 hanging glass fixtures (1 broken.)  
stove hole east side wall,

wide trim w/ single bead.

\* window at rear is an obvious sump. Sl. sash. square frame

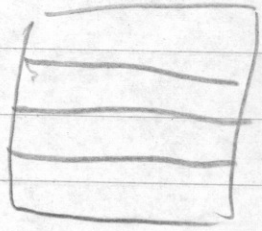

wide baseboards. - can see where pins were located  
not painted there. note on card,

← 14 Total.

Pens; plain slab pine benches  
seats set at an angle.

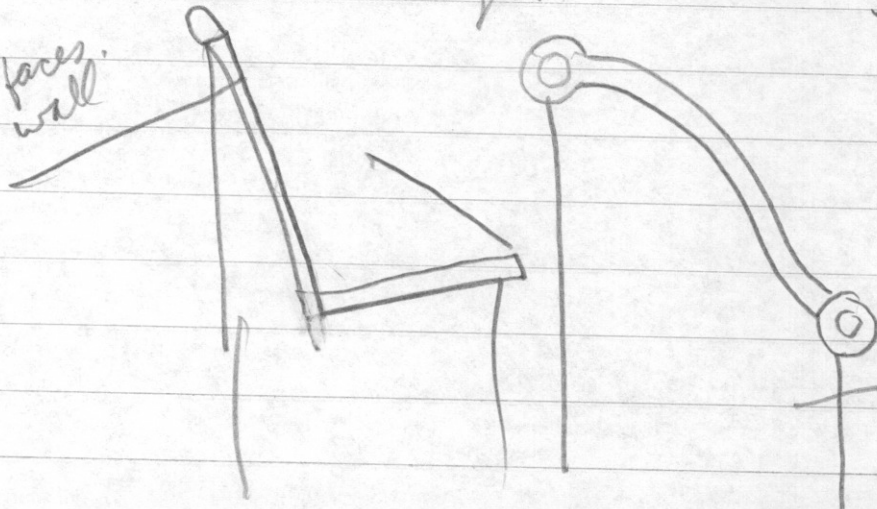

furn. practically all  
gone. some benches remain.  
Cubing is bad in places,  
some floor joists may be gone  
water damage on floor  
window panes may  
walls cracked.

platform c 3/4 way back faced w/ pine paneling.

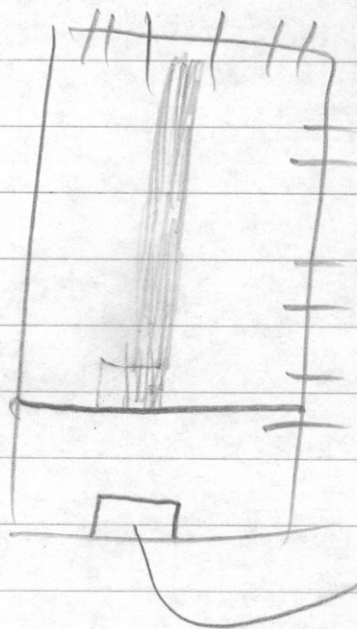

raised 8 1/2"

alter? 3 panel moulded

center of floor is raised — summer beam?

windows are large raised 2'2" off floor

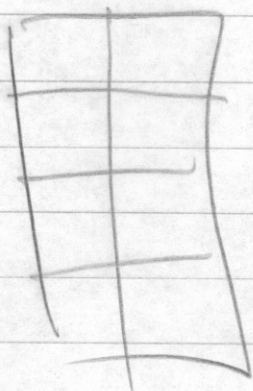

6'4" tall x 36 1/2" w

walls c 4 1/2 - 5" thick

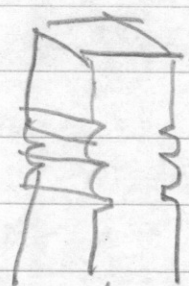

1. Rail w/ ~~var~~ turned bal. leaning against front wall

2 part. 7' long x 3' high w/ square post. stained d. crown