

BUCKLAND HALL AKA. BUCKLAND FARM

76-32 3-9

10:30-3:30

Owner: Thomas Mellon Evans
8230 Buckland Mill Rd.

DON ROBERTSON - MGR.

500 ACRES.

ROUGHLY COURSED?
Red sandstone random-laid w/ mortar
STONE FOUND. + WALLS
SLATE ROOF

Evans purch. B.H. from in 1956
from Gallagher's Steak House
of N.Y.

2-story porch added later.
mortared w/ portland cement?

OUTBLDGs

NOTE STONE SPRING house (?) at front
photographed

Evans grad. Yale 1931

Board chairman of H.K. Porter Co.

and Crane Co.

Cemetery - 1 stone ^{legible.} SAMUEL LOVE
other graves

OUTBLDGGS.

Barns were cattle barns
Tenant Houses? maybe first two
houses on the left.

1. main House
2. Wood man Barn
3. Mgr's House
4. Yearling Barn
5. OLD BARN - Burned.
6. Hay SHED

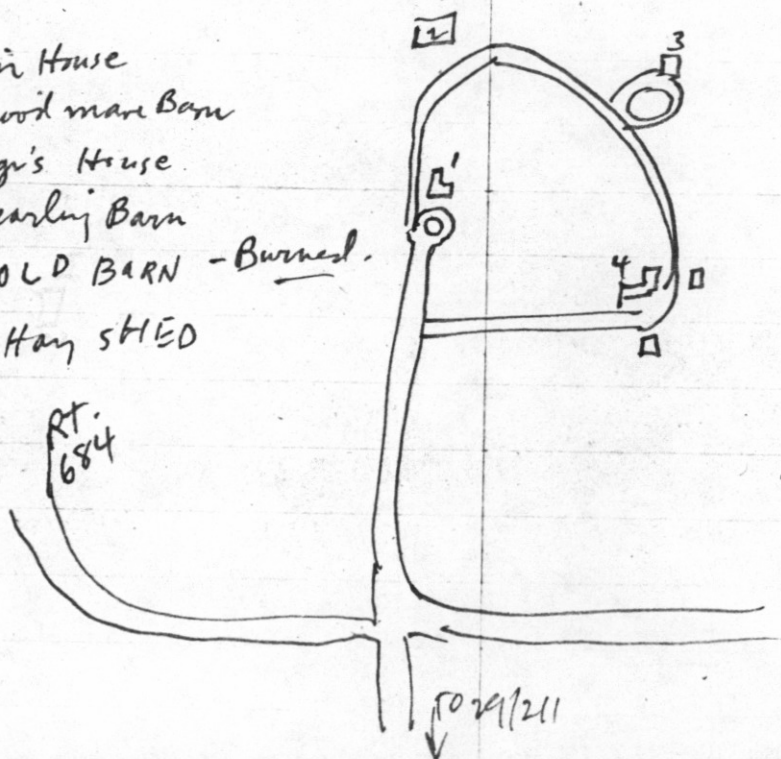

364
 910
 910
 5424
 56 ft.

FRONT DOOR =

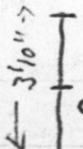

6'10 high

SPANELS NOT DEEPLY RECEIVED

POSSIBLY FILLED, B. Beaded on inside

PORCH POSTS = 1 1/2\"/>

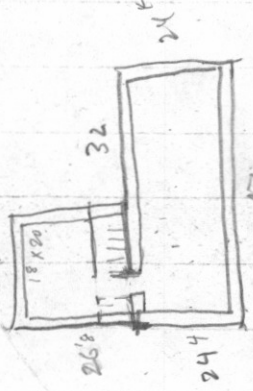

PR. CASSEMENT 6 X 6
 WINDOW ONLY AT BASELINE LEVEL

MOULDING CORNICE

1/2 window sills

1 1/2\"/>

22\"/>

286

walls = 18"

18

20

raised 1st floor high Basin

26 1/2\"/>

65"

97"

95"

93"

91"

Stone encl porch shed roof

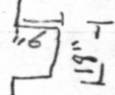

8'3\"/>

9'10"

9'11"

9'11"

9'11"

9'11"

9'11"

9'11"

9'11"

9'11"

9'11"

9'11"

32
 21
 53

18
 18

364
 910
 910
 46'2"

469
 7/4

364
 910
 910
 5424
 56 ft.

434
 410

Basement rem. in 1940's

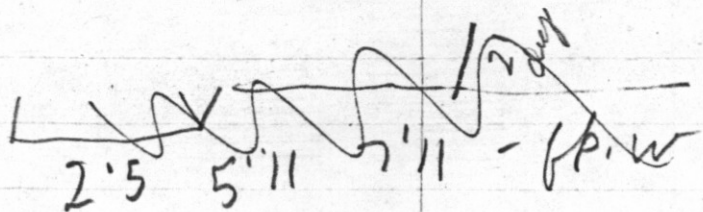

F.B. stone - no mantel downstairs el.

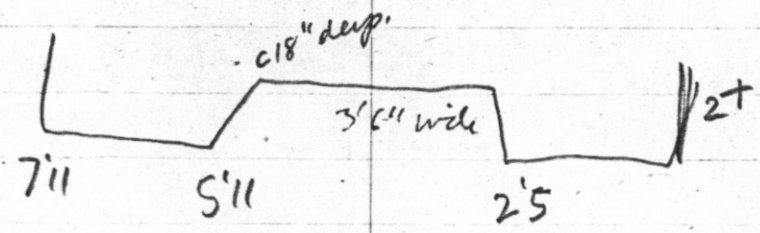

looks like a warming k. or pantry.

- FRONT DOOR -
- W. MOUNDINGS -
- SCULPTURE -
- CORNICE -
- gable END ✓

HALL

back,

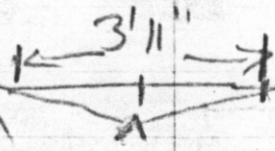

To C.R.

doorway = 10' 2"

20' 4"

FRONT DOOR

inside
Single bead,

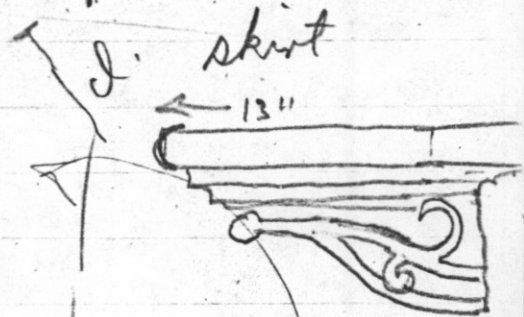

d. skirt

13"

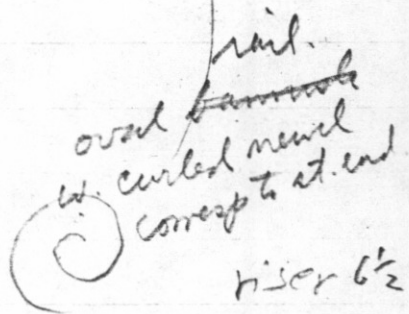

rail.
oval bannister
w. curled newel
correspond to st. end

riser 6 1/2
tread 11

45 1/2" w



plain square
v. thin

Wainscoting
under stair

14' 2"

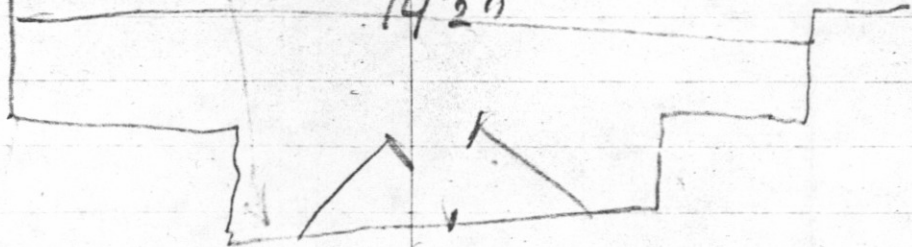

LR,

Library

F.P. = 90W x 67 1/2 H

opening = 50 x 36 x 24

12 | 90
84
6

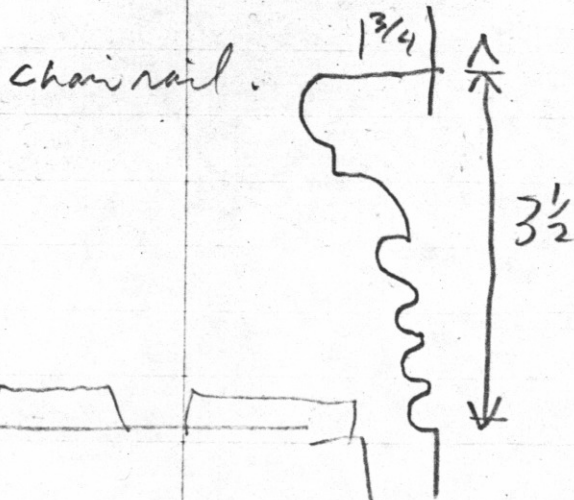

walls = 18" deep.

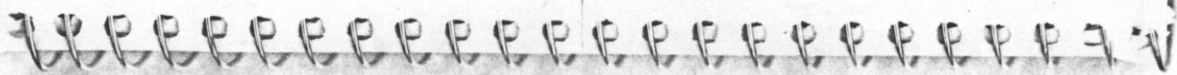
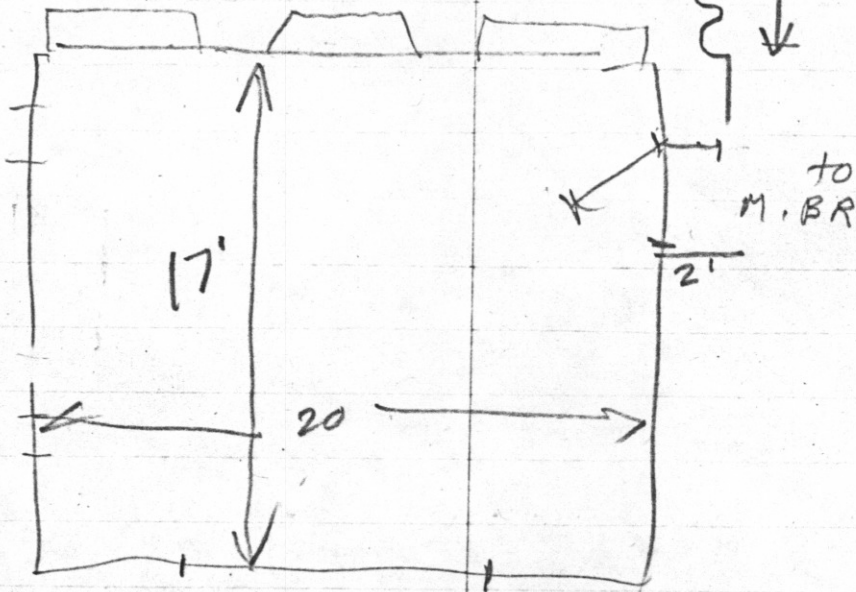

PARLOR

doors = 3 panels

clowled in pine,
heavy - 1/4" raised panels

174
16
1810

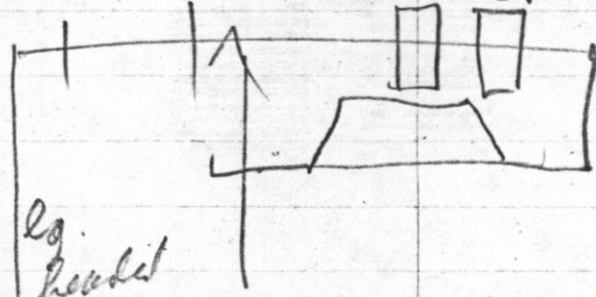
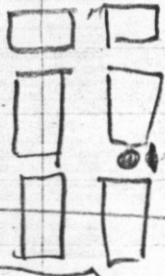
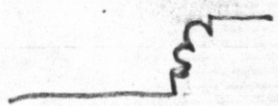
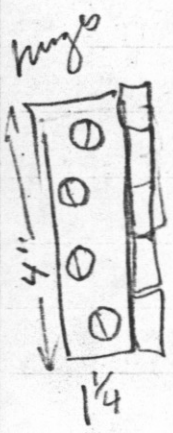

lg. headlet screws
1/2" across

1810

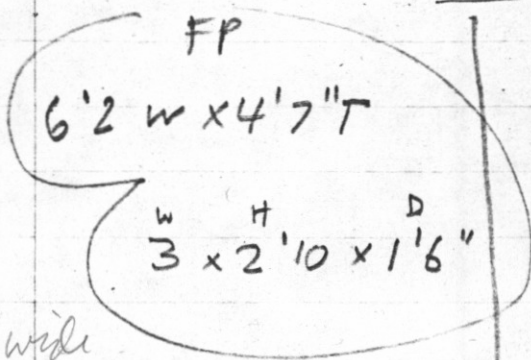

doorway = 2'11" wide

FLOORS
65' - 7" wide
nailed to joists
pine.

20'3

Chain rail = 1/2

mouldings =
5 1/4 wide
needed
6 1/2 needs @ 2"

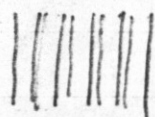

needed
3 needs @ 2"

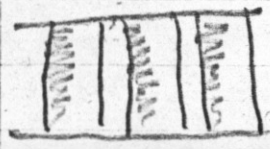

4"

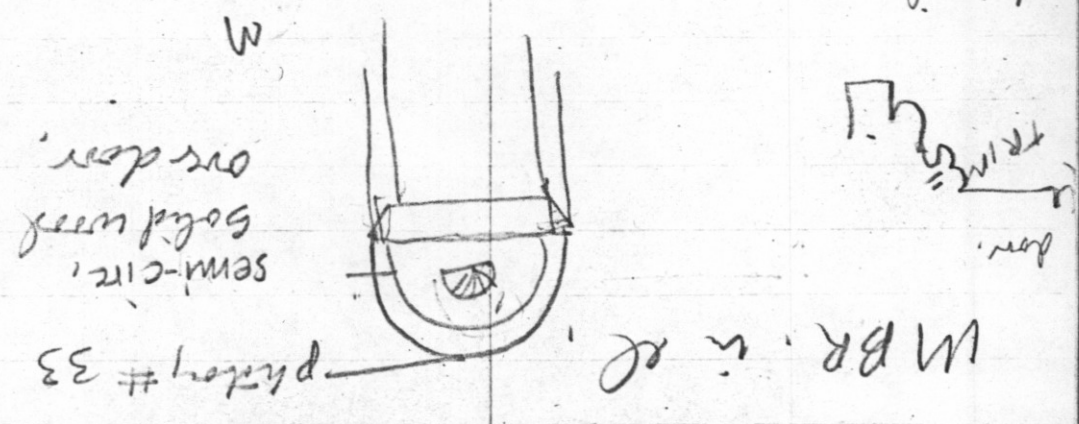
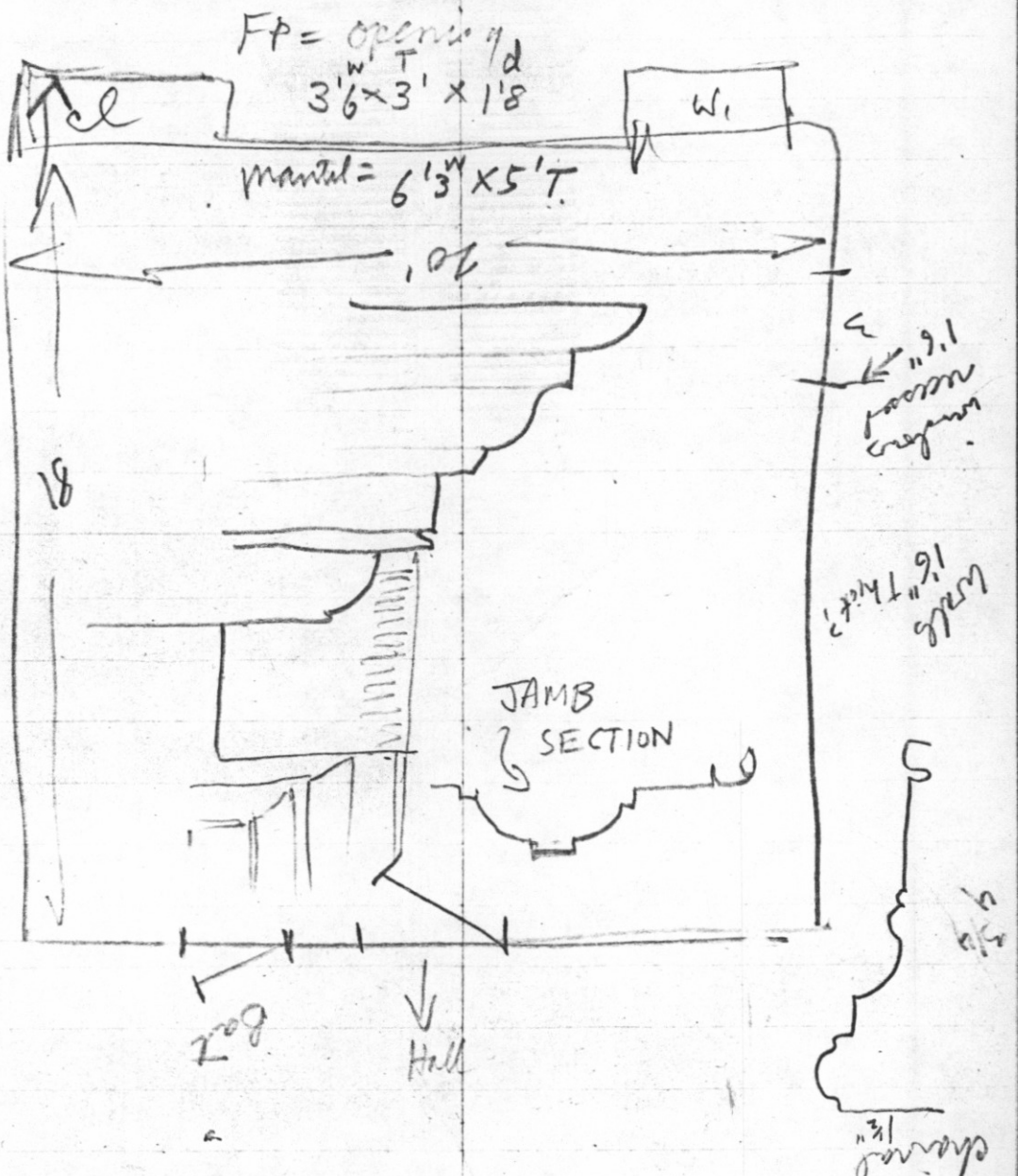

Back stair hall

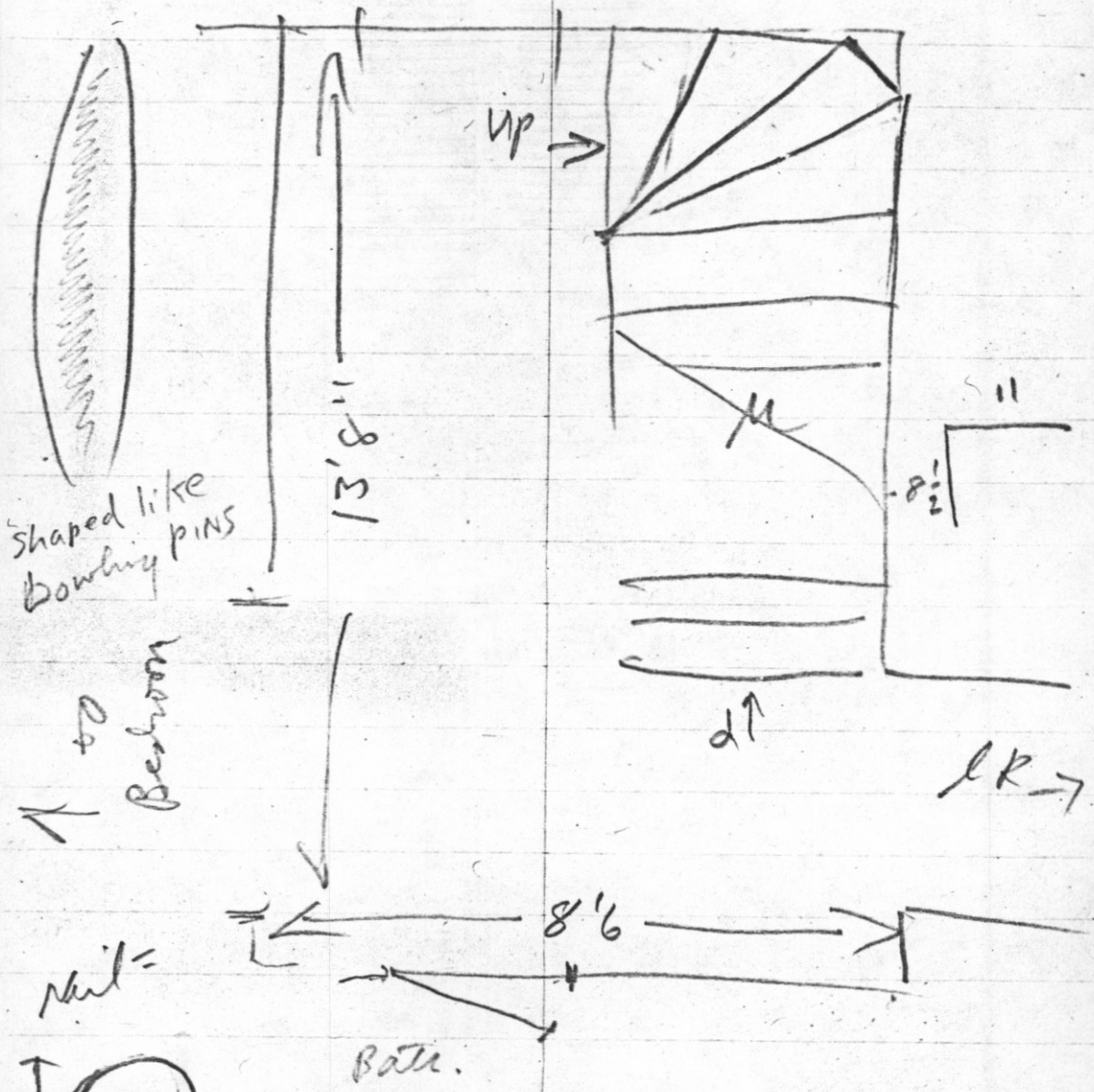

Order of rooms photos:

1ST FLOOR

- 21 L. R. FIREPLACE - too dark,
- 22 " " DOOR TO MAIN HALL
- 23 " " " TO "BACK HALL
- 24 LIBRARY FP (WEST ROOM)
- 25 MAIN MOULDING & WINDOW
- 26 HALL STAIR
- REPEAT OF EAST FP
- 29 WOOD-WORK OVER DOOR TO E. ROOM
- 30 UPSTAIRS - EAST BR MANTEL
- 31 WEST " "
- 32 SEMI-CIR. DOOR
- 33 BACK BEDROOM MANTEL
- 34 1ST FL. MASTER BR.
- 35 BACK HALL STAIR
- 36 BASEMENT - FP IN DINING RM
- 1ST FL - OVER DOOR TRIM IN
MASTER BR.
- 1ST FL - TRIM OVER MAIN ENTR.

3 EXTERIORS