



VIRGINIA
HISTORIC LANDMARKS COMMISSION

File no. 76-112
Negative no(s). 4348, 4360 &
4362

SURVEY FORM

Historic name Buckland Mill	Common name Calvert's Mill
County/Town/City Prince William County	Factory Mill
Street address or route number 7980 Buckland Mill Road, Gainesville, VA	
USGS Quad T. Gap	Date or period c1899
Original owner George W. Calvert (?)	Architect/builder/craftsmen
Original use Grist Mill	
Present owner Mr. & Mrs. Russell A. Stuart	Source of name
Present owner address 7980 Buckland Mill Rd. Gainesville, Va.	Source of date Owner, Published book, arch. evidence.
Present use Storage	Stories 2½ on a high basement.
Acreage ±30 acres.	Foundation and wall const'n Stone foundation, frame walls.
	Roof type Metal covered gable roof.

State condition of structure and environs **Mill in good condition. Much of interior workings still in mill, though bell turbine gone.**
State potential threats to structure **None.**
Note any archaeological interest **Foundation or site of earliest mill & mill race on property.**

Should be investigated for possible register potential? **yes ___ no ___**

Architectural description (Note significant features of plan, structural system and interior and exterior decoration, taking care to point out aspects not visible or clear from photographs. Explain nature and period of all alterations and additions. List any outbuildings and their approximate ages, cemeteries, etc.)

Mill once had a 1-story porch across the front, or south gable end, which was used as a loading dock. One-story garage added by present owner. Mill was first powered by a Bell or vertical (?) turbine, located in the basement of structure. At the time it ceased operation, the mill was being powered by a diesel engine located off the west side of the building.

Beams in 1st and 2d stories are circular-sawn and measure 10"x14"; posts are 9½ square, and are corner-braced. Interior, 1st and 2d floors, once finished with beaded siding. (Some has been removed.) Interior walls, ceiling and supports throughout were once white-washed. Posts and beams in 3d floor, including both structural and those supporting the mill machinery, are hand-hewn and/or pit-sawn and contain unused mortises, as if they had been used elsewhere previously. Most of the remaining mill equipment & machinery is located (or stored) on the 3d floor. Most of the elevators have been removed in the 1st and 2d floors, but remain intact on the 3d floor.

Mill machinery consists of six "Challenge Revolving Sifting Bolters" made, according to the label, by the Fpur & Cereal Machinery Mfg. Co., Battle Creek, Mich. These bolters come in stacked pairs which measure 7'6" high x 2'6" deep x 6'3" wide. The metal parts of most of these machines are either broken or have pieces missing. There is also an "Air Circuit Sieve Scalper and Grader", made by the same Battle Creek company. It measures 5' high x 7' wide x 2'6" deep. (Machines date to early 1900s.)

The grain carriers, or elevator belts, ran through the central section of the mill. Many of the white-washed, poplar (?) shafts, measuring 6½" square, are still intact or are stacked in heaps on the 2d and 3d floors.

There is a chaff remover with an overhead conduit to the outside, located toward the back of 3d floor.
Interior inspected? **Yes.**

Historical significance (Chain of title: individuals, families, events, etc., associated with the property.)

Buckland Mill was operated as a modern flour mill by George Calvert from about 1899 to 1919. The tradition of mill operation in the Buckland area began with Samuel Love, who owned a grist mill on Broad Run in 1785, at the time he wrote his will. Further downstream, Kinsley Mill, and its granary were built in about 1794 by Samuel Love's sons, John & Charles. In 1797 John Love* built a grist mill upstream from the present Buckland Mill. Sometime after 1835, a large woolen mill was established on Broad Run, approximately where the present Buckland Mill is. This was a large, 3-story frame structure measuring 40x60, with a stone dye house nearby. This woolen mill, which was so prosperous that Buckland was called the "Lowell" of Prince William County, was dismantled in the late 19th-early 20th century, and material from it, including wooden beams were used by Calvert in the construction of the present mill.

The woolen mill on this site was held for a time in August, 1862, by Union forces. In October 1863, Buckland was the site of a skirmish between General Custer's brigade & General JEB Stuart's forces.

The present owner acquired the mill, miller's house & surrounding c30 acres in about 1940. He removed some of the milling machinery to the 3d floor to convert the 1st floor of the mill to a stable for horses. Some of the machinery, including the bell turbine, was sold for scrap metal. The mill is presently being used as a workshop and for storage.

* During the late 18th & early 19th century, Samuel and John Love were instrumental in promoting the construction of the Warrenton-Alexandria Turnpike. By 1824 the road was completed to Buckland.

Sources and bibliography
 Published sources (Books, articles, etc., with bibliographic data.) R.J. Ratcliffe, This Was Prince William (1978) p.101.; Writers' Project, W.P.A., Prince William, The Story of Its People and Its Places (1941, 1961), pp. 171-173. Martha Leitch, "Buckland, Prince William Co., Virginia," in Echoes of History, Vol. 3, No.6 (Nov. 1973), pp.81-87.

Names and addresses of persons interviewed
 Russell A. Stuart (Owner of Buckland Mill).

Plan (Indicate locations of rooms, doorways, windows, alterations, etc.)

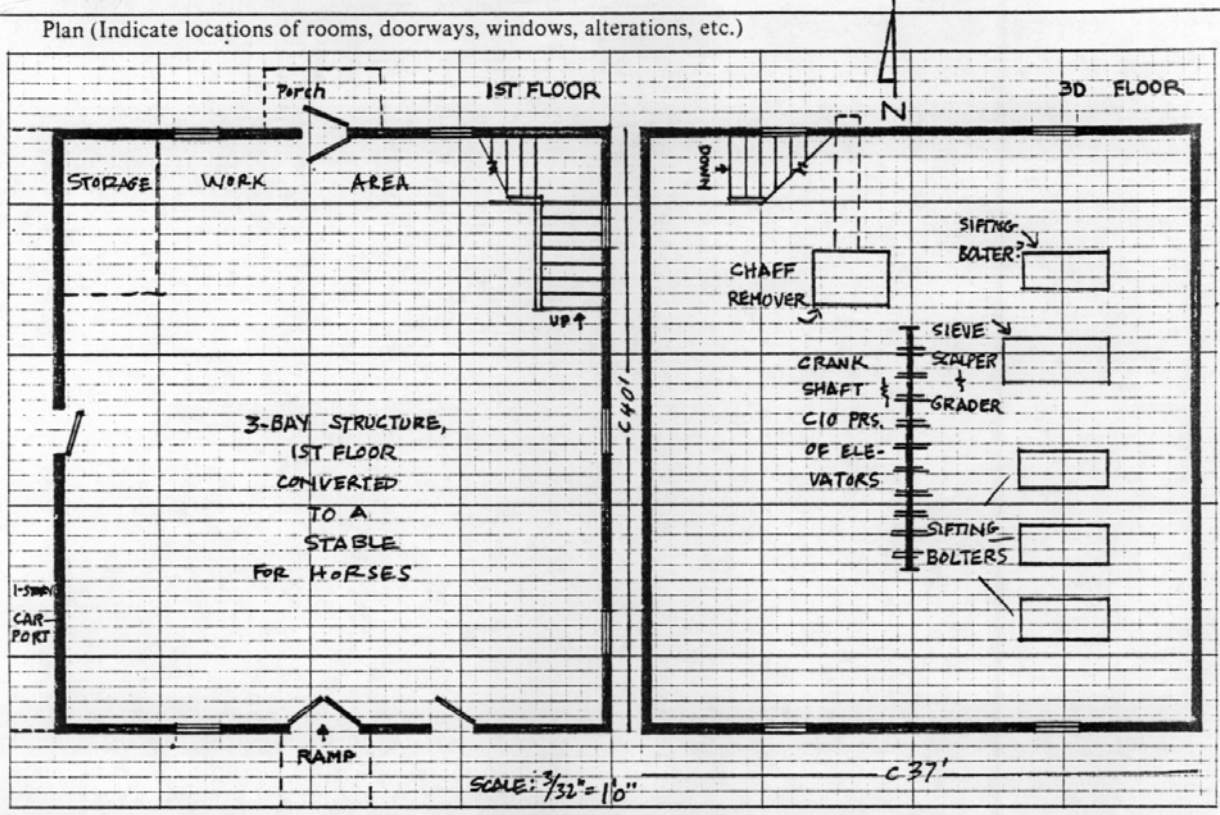

Site plan (Locate and identify outbuildings, dependencies and significant topographical features.)

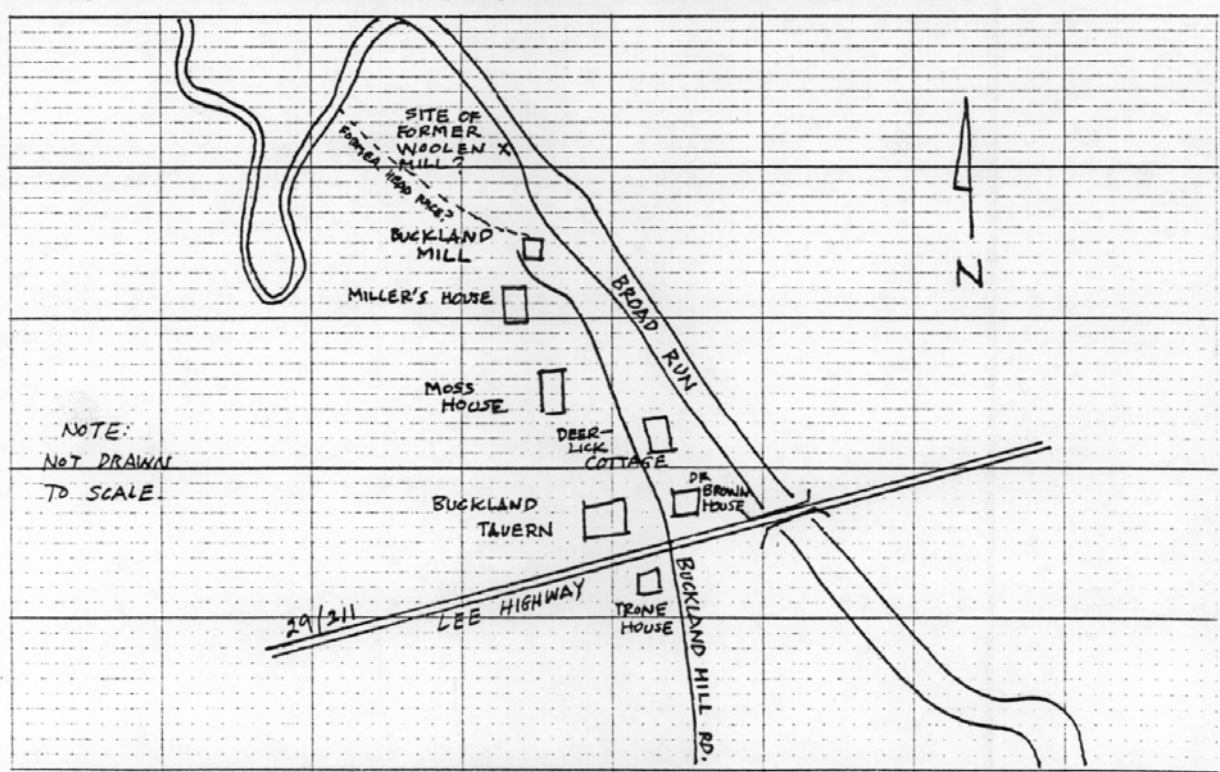

Name, address and title of recorder
 Frances Jones, Architectural Historian - Surveyor, NVPDC

Date
 MAY 197
 MAY 197

Buckland Mill 76-112

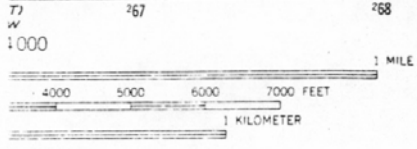
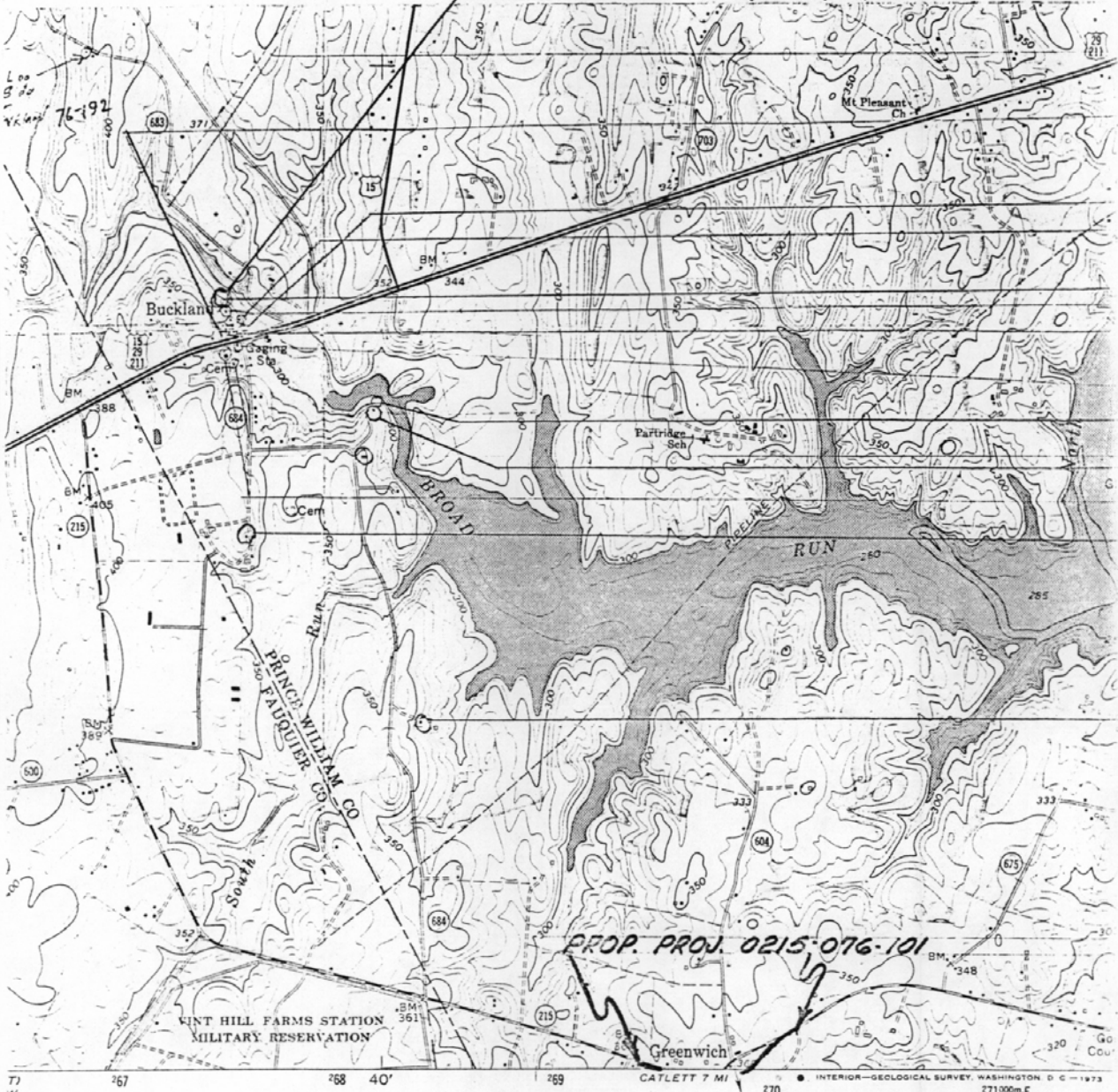

MAP ACCURACY STANDARDS
 U.S. GEOLOGICAL SURVEY, WASHINGTON, D. C. 20242
 U.S. GEOLOGICAL SURVEY, CHARLOTTEVILLE, VIRGINIA 22903
 U.S. GEOLOGICAL SURVEY, D. C. SYMBOLS IS AVAILABLE ON REQUEST

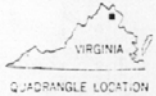

QUADRANGLE LOCATION

Revisions shown in purple compiled in cooperation with
 Commonwealth of Virginia agencies from aerial photographs
 taken 1972. This information not field checked

ROAD CLASSIFICATION

- Primary highway, all weather, hard surface
- Light-duty road, all weather improved surface
- Secondary highway, all weather, hard surface
- Unimproved road, fair or weather

- U. S. Route
- State Route

THOROUGHFARE GAP
 N3845—W7737.5/7.5

1966
 PHOTOREVISED 1972