

King King
2021/11/11
11/11/21

Ms. Betty Pickett

2714 Logmill Rd.

Ellen Veil

754-7359

Kincheloe
Hooe to Butler

Samuel Poland -

P193.

either Carter of Blackburn.
(L.B.R. Tract.)

Blooms House

→ within before 1869.

Chain of Title

off Butler's Birmingham, Nov. 1869
sale from Lewis B. & Susan Butler to
James Greene.

[IN TRUST TO JOHN M. BUTLER.]

deed - July 1876 ~~to~~ Cristina S. Greene to
Louisa M. Greene

Oct 1882 Louisa M. Greene to Abraham &
Isaac Rickard. D.B. 34 p. 198.

Jan 1891 Abraham Rickard to
Alvin H. Rouse

Aug 1893 A.H. Rouse to M.C. Bennett.

Mar 1900 A.H. Rouse to E.R. Corner

Aug 1972 E.R. Corner, jr. to city of Manassas Park.

1876
1893

Case of Birmingham
deed

Manassas Park
deed

Manassas Park Social Services

can see it from railroad tracks

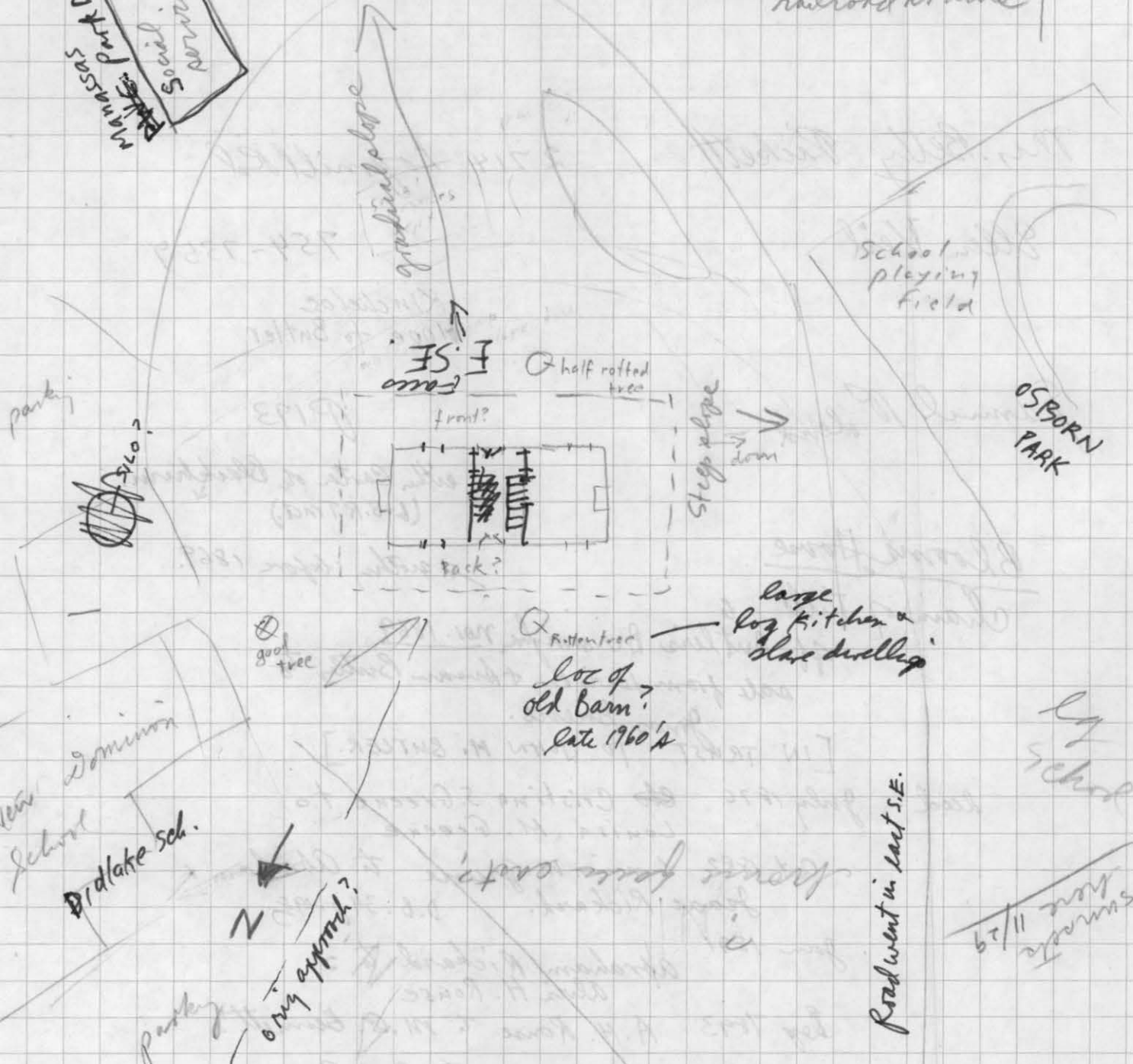

11/28

roof - cedar shingle
older part - beams were hewn.
newer part - sawn beams

Conner Farm

Conner Drive?

Manassas Park

came off Birmingham property

orig 80 acres
Blomington 275 acres

(AN OLD MAP SUGGESTS THAT HOUSE WAS REACHED BY DRIVE FROM NORTH ALONG RIDGE. [STILL THINK IT FRONTED SOUTH.]

6/11 1976