



VIRGINIA HISTORIC LANDMARKS COMMISSION

File no. 76-76
Negative no(s). 4351

SURVEY FORM

Historic name Ewell's Chapel or "Rescol" Common name Grace Chapel
 County/Town/City vic. Hickory Grove, Prince William County
 Street address or route number Loudon Drive, Haymarket, Va.

USGS Quad Middleburg 7.5 Date or period c.1847
 Original owner Dr. Jesse Ewell Architect/builder/craftsmen
 Original use Chapel
 Present owner St. Paul's Episcopal Church Source of name
 Present owner address Haymarket, Va. Source of date Prince William, Its People & Its Places, Stories 1
 Present use Not in use Foundation and wall const'n Stone foundation (24" thick); frame walls.
 Acreage-1 acre (56 sq. poles) Roof type Gable; metal-covered

State condition of structure and environs Deteriorating owing to neglect. Foundation missing along north side; floorboards missing; sills deteriorated & building sags; windows broken, some msg.
 State potential threats to structure Present bad condition is a threat; owner may demolish.
 Note any archaeological interest

(Determination of eligibility letter sent 1974. No answer VHLC.)

Should be investigated for possible register potential? yes X no

Architectural description (Note significant features of plan, structural system and interior and exterior decoration, taking care to point out aspects not visible or clear from photographs. Explain nature and period of all alterations and additions. List any outbuildings and their approximate ages, cemeteries, etc.)

Exterior: 1-story frame on high, stone, stuccoed foundation, 47" high at front to 1' at back. Found. - 2" thick. Covered with channeled siding. Painted light yellow with brown trim (both faded). Gable metal-covered roof. Cornerboards. Box cornice. Central entrance via 1-st. gable-roofed frame porch containing 5 steps. Porch has ogee arch and is clad with vert. tongue & groove siding. 2-panel double door, hardware missing.

Flanking gothic-arch sash windows, upper portion with tracery mouldings. One pair of arched windows along each side. Small apse or altar with flat roof at rear on raised platform.

Overall dimensions: 30'5" x 24'.

Interior: dimensions: approx 29' x 23' with raised altar at west end. Height to ceiling: c. 18'.

Barrel-vaulted ceiling covered with 5 to 12-inch wide tongue & groove boards in 3 sections of 10' lengths.

Interior walls covered with 4½ to 6" tongue & groove planks laid horizontally. Windows - 2 in each of the long sides and 2 at east end - are gothic arched sash type 3/2. Windows are flanked by simple pilasters having simple box capitals.

Altar is reached through a rounded arch flanked by pilasters. Arch has a key motif in center.

Floor, laid in 10½" wide (+ -) tongue & groove pine, is supported by a longitudinal beam (summer beam?) 8" x 10½" x 29' that runs from front to back and is mortised to carry the 11 or 12 foot long floor joists that run from center to outside walls. Center beam is supported at the center point by a pile of stones laid in a column.

Metal pole or brace at mid-point along each side (north & south) at about rafter height appears to function as reinforcement. (continued on separate sheet)

Interior inspected?

Historical significance (Chain of title; individuals, families, events, etc., associated with the property.)

Location: Land for the chapel was donated in 1847 by Dr. Jesse Ewell, and his wife Ellen, owners of the Ewell estate from which the 56 square poles for the chapel was subtracted. The Chapel, first known as Rescol, or Ewell's Chapel, and used primarily by the Methodist Episcopal was finally named Grace Chapel by St. Paul's Episcopal Church, who bought it from Sudley Methodist Church in 1884.

The chapel sits at the entrance to Edge Hill and Dunblane, home of many generations of Ewells, including Alice M. Ewell. Though it is now known as Loudon Drive, the gravel road running parallel to Rt. 15 on which Grace Chapel sits is the Old Carolina Road.

During the Civil War, Col. John S. Mosby and his men were familiar figures in this part of the county and frequent visitors to the Ewell homes. In June 1863, Mosby and 25 of his men were ambushed at Grace Chapel by Union Forces under orders from General Meade. The attack failed, and Mosby and his men fled to safety in the mountains.

The body of a soldier wounded during a similar military encounter here is buried somewhere in the churchyard.

In 1973-1974 an unsuccessful attempt was made by a group in Prince William County to rescue Grace Chapel from almost sure demolition. A fund-raising campaign netted over \$2,000 of the estimated \$9-10,000 to repair the structure. The support of charitable and service organizations was obtained; the Chapel's history and present plight were outlined in articles which appeared in the local newspapers; and a request was made of the VHLC to make a determination on whether the Chapel had landmark status, thus qualifying it for much-needed government (continued on separate sheet)

(Architectural description continued)

Changes to Structure: Source: "Grace Chapel - Historic Landmark in Danger of Extinction" by Janet Newcomb in the Piedmont Virginian 17 Oct 1973.

Restored 1875 to 1881 under direction of Rev. John Ambler minister at St. Paul's. At that time a gallery, which had been constructed for the Black members of the church, was removed. c. 1900 "weatherboarding" was applied and gothic windows installed. (These windows are like those in Bull Run Chapel.) Porch probably added then also.

(Historical significance continued)

assistance. Unfortunately, these efforts could not be sustained long enough, and the Chapel remains today in worse condition than ever.

(Sources continued)

R. Jackson Ratcliffe, This Was Prince William (1978), p. 27.

Alice Maude Ewell, The Virginia Scene, or Life in Old Prince William (1931).

Edmonia Taylor Sinclair, "Grace Chapel, Prince William County, Virginia," pamphlet, n.d.

Tommye S. Burton, "Chapel Faces Uncertain Future," in The Manassas Journal Messenger, 23 Nov 1973, p. 7B, and 28 Nov 1973 (2-part article with photographs).

Janet Newcomb, "Grace Chapel, Historic Landmark in Danger of Extinction," in Piedmont Virginian, 17 Oct 1973, p. 11.

GRACE CHAPEL (76-76), PRINCE WILLIAM COUNTY

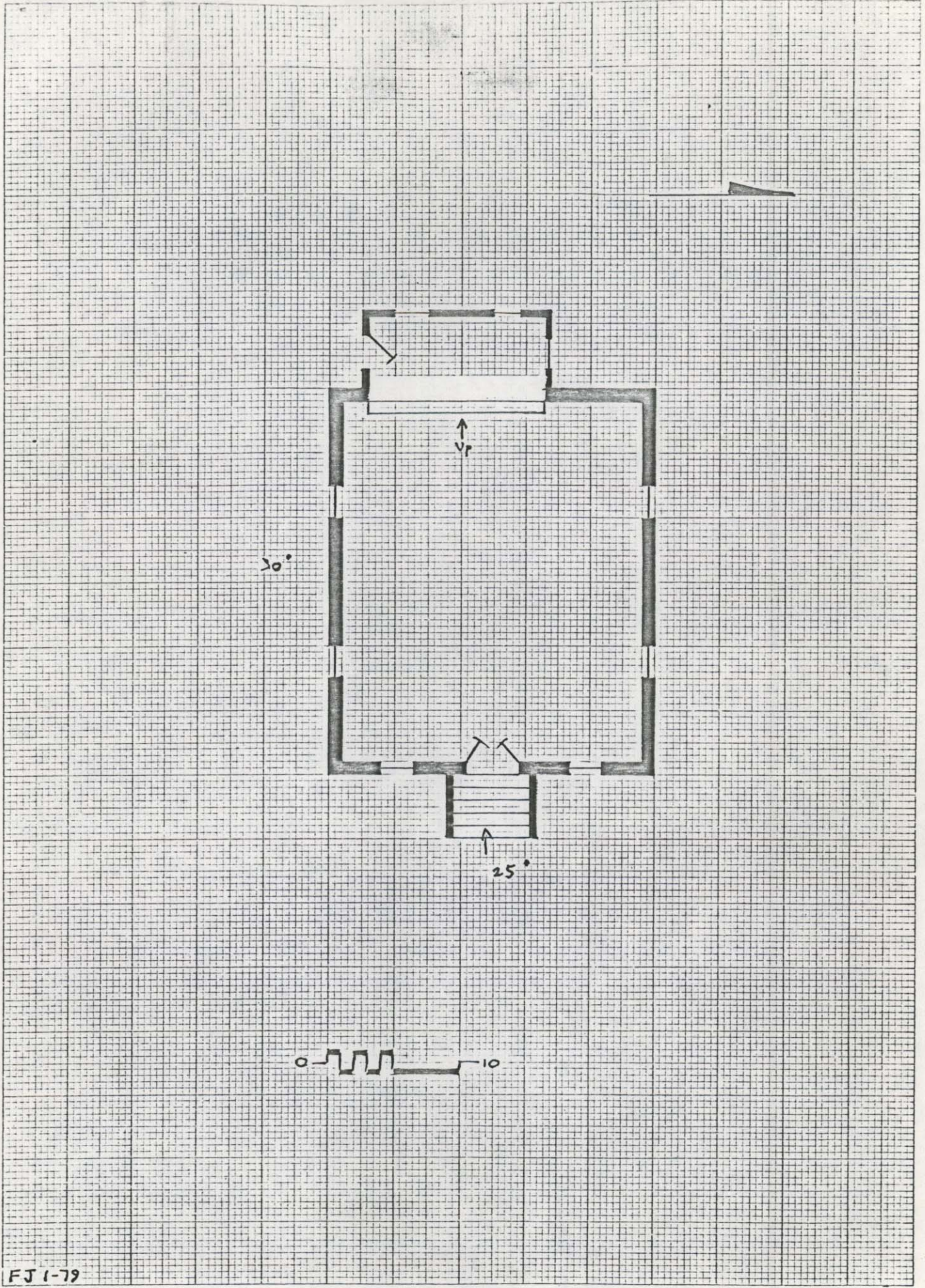

FJ 1-79

Sources and Bibliography

Published sources (Books, articles, etc., with bibliographic data.)

Prince William; the Story of Its People and Its Places (1941, 1961), pp. 193-194. (Cont.)

Primary sources (Manuscript documentary or graphic materials; give location.)

Deed dated 10 Aug 1847, County Clerk's Office, P. W. County Courthouse, Liber 19, Folios 415-416.

Names and addresses of persons interviewed Mrs. Janet Newcomb, 2106 Youngs Drive, Haymarket, Va. 22069; Mrs. Sue Coe, 2705 Logmill Rd., Haymarket, Va. 22069.

Plan (Indicate locations of rooms, doorways, windows, alterations, etc.)

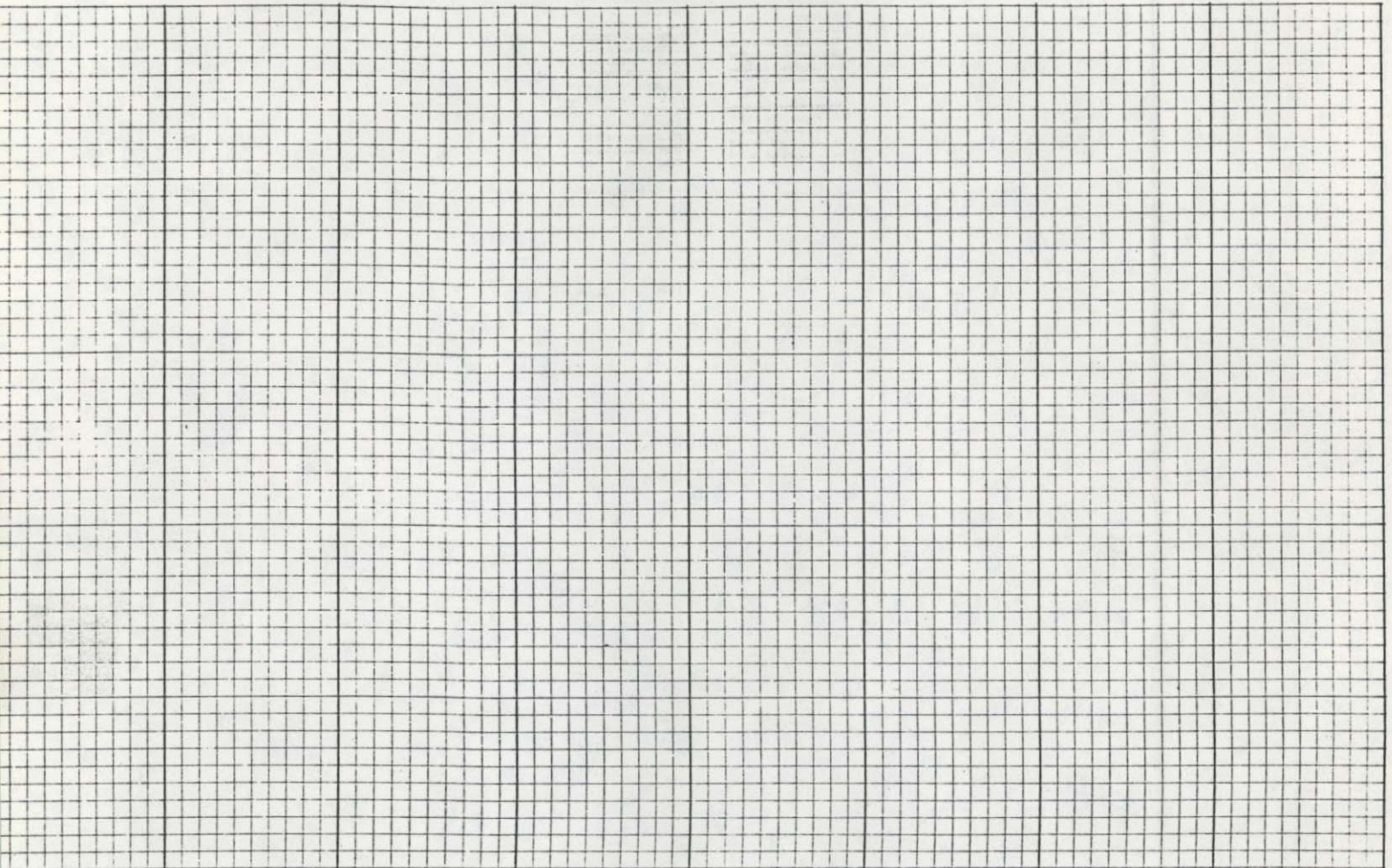

Site plan (Locate and identify outbuildings, dependencies and significant topographical features.)

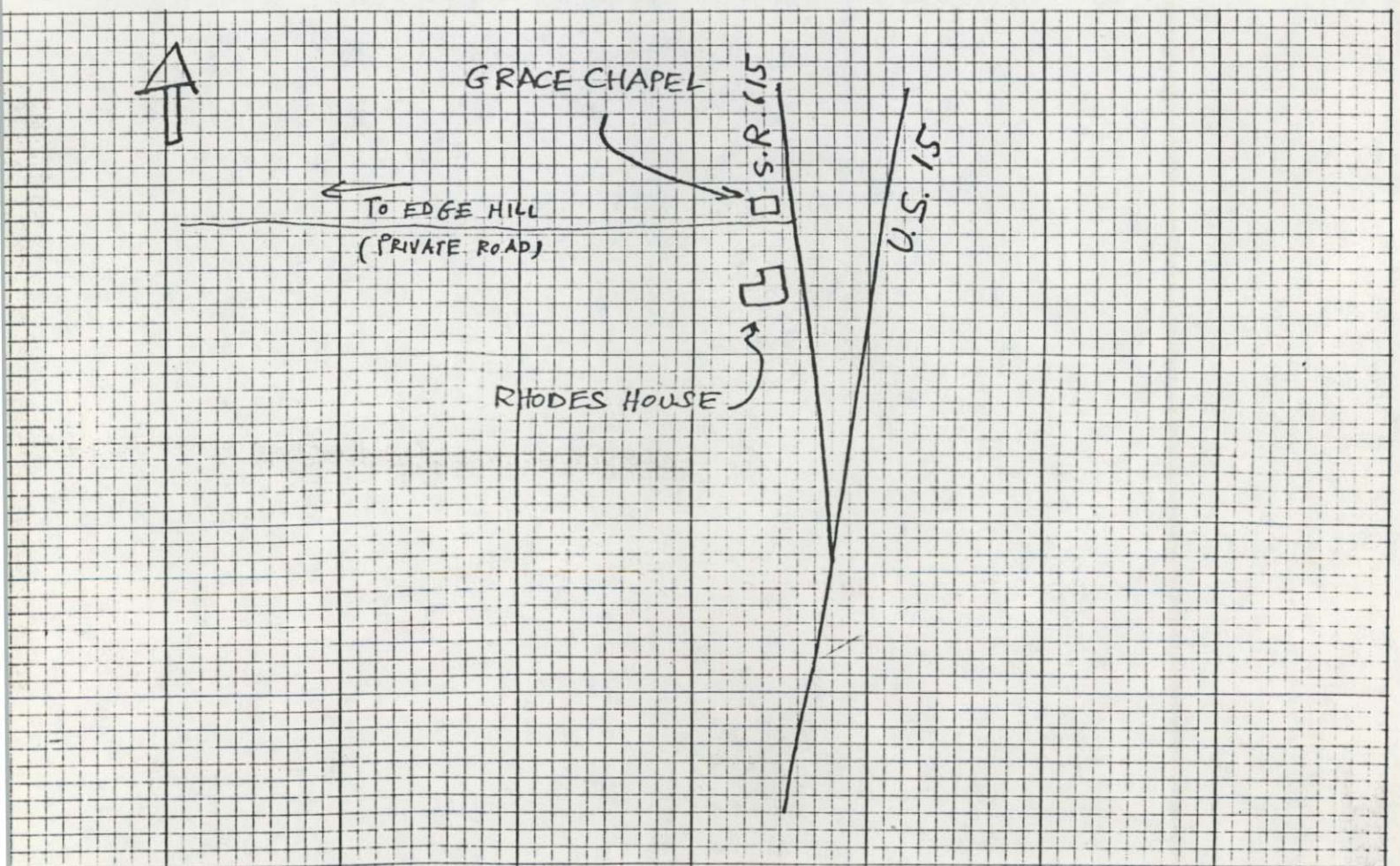

Name, address and title of recorder

Frances Jones, Architectural Historian/Surveyor, NVPDC

Date

October 1978