

formerly 26A.

119-01-47

8241 Buckl. Mill Rd.

DR. RICH. E. DEBUTTS

WICKLOW

UPPERV. VA. 22176

DB 165 P7

14,764

TAXES 1979 = 650.

metal roof
2 st.

6 rooms or 8 Rooms.

wood fl.

unfin basem. (part)

119-01-47A = TOWN OF MAN

8243 Buckl. M. Rd.

11.23A

DB 414-292

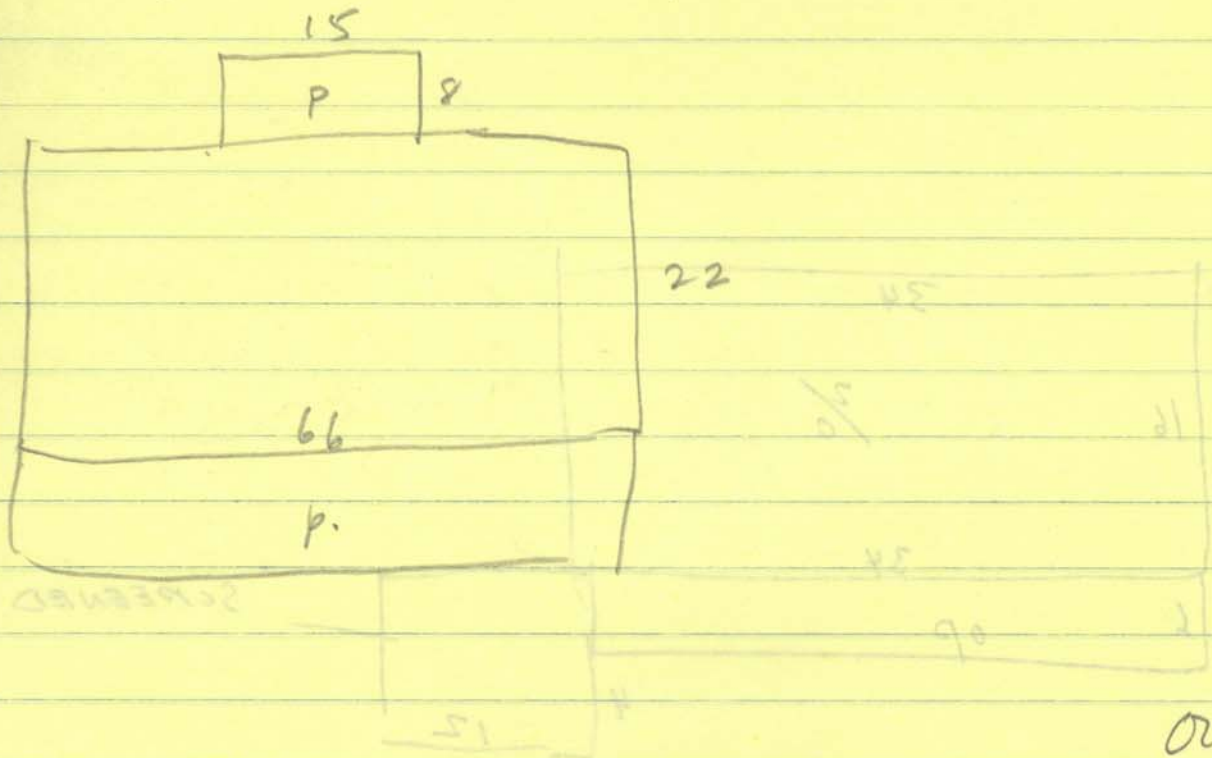

formerly Charles Hinton?
and →

\$\$\$

over



James 20A

DB 162 97

14.76 A

TAXES 177 + 224

19-01-47
Roni Buck, Will R

DR. RICH E. DEWITT

WICKLOW

UPPER VA. 23174

11-01-17A = 17A = 17A = 17A

2003 Buck, W. R.

11.76 A

DB 162 97

$$\begin{array}{r} 34 \\ 12 \\ \hline 46 \end{array}$$

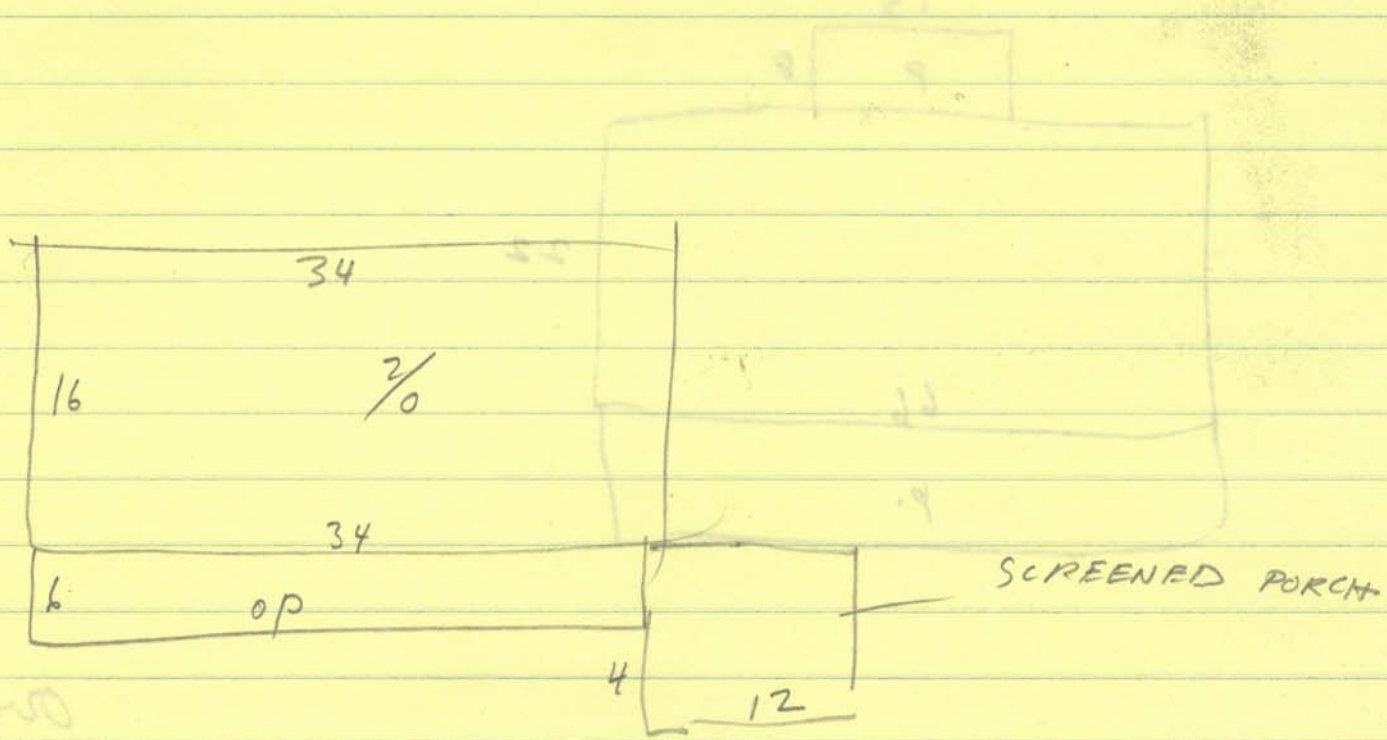

Over

17A

James, Charles Hunter
17A