

Wm A. Dade

William French

5-11-1818 485.00

"Eral"

~~541-1-1818 50~~

plus division to Adams tract of 916.5
between Wm Dade, Wm French & Lawrence G.

Alexander.

Exchange of 50 acres from Alexander to Dade

Edward Dade 435.00 to Wm Dade.

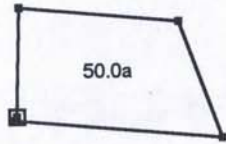

Item 55

!

! Abstracting info.

Typ deed

Id

Ref PW DB 7, p.12

Dat 5/11/1818

Rec

Frm William A. G. Dade

To L. G. Alexander

Con

Re 50 acres

Adj

Wit

!

! Metes and bounds. "Beginning at..."

Pt Box oak & stone

Ln n1.5e; 68.5p;

Pt 2.

Ln s84.417e; 99p;

pt 3.

ln s20e; 78.5p;

pt 4.

ln n84.417w; 129p;

end

return this commission, and thereunto annex a certificate, under your hands and seals, of such privy examination by you taken, and of the such declaration, made and consent yielded by the said Francisina Hubert.

Witness, Philip D. Dawe, Clerk of our said Court, at the Court House aforesaid, this 31st day of March 1818, and in the 42nd year of the Commonwealth.

PWC DB 7 p. 12-16

did owe by 435
165
600 a

From Edward Fitzgerald? to that
was Fitzgerald got for
Hayward?

Prince William County To Wit: We Pursuant to the above Commission, Hubert privy, and apart from her to that she acknowledged she freely sealed the writing to the said Court shewed and explained to her and the said writing may be recorded without giving under our hands one thousand eight hundred and 18

Wm Smith

At a Court of Quarterly Sessions held for Prince W^m County June 1st 1818. This Deed from Julius Hubert & Francisina his wife to Gipe Euell was proved by the oaths of P. D. Dawe Arch. Lawson Wm French as to the execution by Julius Hubert and (together with a declinimus for the privy examination of the former) Ex^o ordered to be recorded.

Teste, Phil. D. Dawe Clerk

This Indenture made this Eleventh day of May in the year One thousand Eight hundred and Eighteen by and between William M. G. Wade and Elizabeth Westwood his wife, of Falmouth of the one part, and William French of Prince William County of the other part, Witnesseth that the said William and

and Elizabeth for and in consideration of the sum of four thousand
six hundred and twenty dollars to them in hand paid, the receipt
whereof is hereby acknowledged, and of the further sum of six thousand
dollars which the said French had secured to be paid unto them
by future installments, have granted, bargained and sold, and by these
presents do grant, bargain and sell unto the said William French
and his Heirs All that Tract and parcel of Land on Cedar Run in
Prince William County on which the said Dade lately resided, and on
which the said French now resides, commonly called Corral, estimated
to contain Four hundred and Eighty five acres (be the same more
or less) the tract not being sold specifically by the said French according to
the well known survey made by T. Cox on the division of the Tract
formerly Helms, between the said Dade, French, and Lawrence G.
Alexander, which survey is referred to for a more accurate definiti-
on of the lines and boundaries of the Tract. The said Tract contain-
ing Four hundred and thirty five acres of the Land purchased by said
Dade of Edward D. Fitzhugh and Fifty acres exchanged by Lawrence
G. Alexander with said Dade for a portion of the Tract which
he as aforesaid bought of Fitzhugh. To Have and to Hold the
said Land with all and singular its appurtenances of every Char-
acter and description, to him the said William French and his Heirs
To his and their only proper use and behoof. And the said William
M. Dade for himself and his Heirs doth Covenant with the said
William French his Heirs and assigns that the said Land is free of
all incumbrance except the Lien of the Mutual Assurance Society
against fire of the state of Virginia, the House and Kitchen being
insured therein and of course liable to the constitution, Laws and Regu-
lations of that society. And in like manner for himself and his Heirs
he covenants to and with the said French his Heirs and assigns
that he and they will in all future time make and execute to the
said French his Heirs and assigns, and at the sole expense and cost
of the said French his Heirs or assigns, such further conveyance for the
more full and perfect transfer of the said Land, as by his or their
Counsel learned in the Law shall be legally & justly required.
And further the said William M. Dade for himself and his Heirs the
said Land with the appurtenances unto the said French his Heirs and
assigns against all lawful Claims whatsoever paramount to that
of the said Dade, shall and will forever warrant and defend.
In Testimony whereof the parties aforesaid have hereunto set their
hands & seals the day & year above written.

Signed sealed and delivered
in presence of

William M. Dade (S)
Elizabeth W. Dade (S)

the within named survey made by Lt. Col. on the Division of the Tract
formerly Helms, between the said Dade, French, and Lawrence by
Alexander, which survey is referred to for as more accurate definiti-
on of the lines and boundaries of the Tract. The said Tract contain-
ing Four hundred and thirty five acres of the Land purchased by said
Spade of Edward D. Fitzhugh and Fifty acres exchanged by Lawrence
by Alexander with said Dade for a portion of the Tract which
he as aforesaid bought of Fitzhugh. To Have and to Hold the
said Land with all and singular its appurtenances of every Char-
acter and description, to him the said William French and his Heirs
To his and their only proper use and behoof. And the said William
M. Dade for himself and his Heirs doth Covenant with the said
William French his Heirs and assigns that the said Land is free of
all encumbrance except the Lien of the Mutual Assurance Society
against fire of the State of Virginia, the House and Kitchen being
insured therein and of course liable to the Constitution, Laws and Regu-
lation of that Society. And in like manner for himself and his Heirs
he covenants to and with the said French his Heirs and assigns
that he and they will in all future time make and execute to the
said French his Heirs and assigns, and at the sole expense and cost
of the said French his Heirs and assigns, such further conveyance for the
more full and perfect transfer of the said Land, as by his or their
Counsel learned in the Law shall be legally & justly required.
And further the said William M. Dade for himself and his Heirs the
said Land with the appurtenances unto the said French his Heirs and
assigns against all lawful Claims whatsoever paramount to that
of the said Dade shall and will forever warrant and defend.

In Testimony whereof the parties aforesaid have hereunto set their
hands & seals the day & year above written.



Signed sealed and delivered
in presence of
Thomas Seddon
Murray Forbes

William M. Dade
Elizabeth W. Dade

Stafford County to Wit:

We Murray Forbes and Thomas Seddon Magistrates of the said County
do hereby Certify that William M. Dade Party to the within Con-
veyance hath duly acknowledged the same before us on the 11th day
of May in the year 1818 and desired us to Certify the said Acknowledg-
ment to the Clerk of the County Court of Prince William in order
that the said Conveyance may be Recorded. As Witness our hands

and seals this 11th day of May 1818

Murray Forbes 
 Thomas Seddon 

Stafford County to Wit

We Murray Forbes and Thomas Seddon Justices of the Peace in the County aforesaid in the State of Virginia do hereby Certify that Elizabeth W. Dade the wife of William A. G. Dade Parties to a certain Deed for the Conveyance of Real Estate to William French bearing date on the 11th day of May 1818 and hereunto annexed personally appeared before us in our County aforesaid and being examined by us privately and apart from her husband and having the Deed aforesaid fully explained to her she the said Elizabeth W. Dade acknowledged the same to be her act and Deed and declared that she had willingly signed sealed and delivered the same and that she wished not to retract it. Given under our hands Seals this 11th day of May 1818.

Murray Forbes 
 Thomas Seddon 

A Table of Courses & Distances

| No | Courses | Dist | No | Courses | Dist | No | Courses | Dist | No | Courses | Dist |
|----|-----------|------|----|---------|------|----|---------|------|----|---------|-------|
| *1 | S 47 E | 15 | 21 | S 72 E | 8 | 41 | S 85 E | 20 | 61 | N 51 E | 8 |
| 2 | S 48 E | 18 | 22 | N 65 E | 8 | 42 | N 74 E | 12 | 62 | N 66 E | 14 |
| 3 | S 41 E | 10 | 23 | N 33 E | 18 | 43 | N 65 E | 24 | 63 | N 61 E | 16 |
| 4 | S 23 E | 24 | 24 | N 40 E | 8 | 44 | S 88 E | 13 | 64 | N 57 E | 12 |
| 5 | S 72 E | 8 | 25 | N 59 E | 24 | 45 | S 46 E | 14 | 65 | N 27 E | 20 |
| 6 | N 86 E | 72 | 26 | N 43 E | 36 | 46 | N 74 E | 9 | 66 | N 22 E | 20 |
| 7 | N 27 E | 19 | 27 | N 35 E | 18 | 47 | N 34 E | 20 | 67 | N 32 E | 9 |
| 8 | S 72 30 E | 14 | 28 | N 45 E | 12 | 48 | N 58 E | 10 | 68 | N 11 E | 30 |
| 9 | S 58 E | 12 | 29 | N 60 E | 8 | 49 | N 84 E | 16 | 69 | N 22 E | 11/19 |
| 10 | N 82 E | 20 | 30 | N 87 E | 14 | 50 | N 77 E | 10 | | | |
| 11 | N 75 E | 12 | 31 | S 60 E | 33 | 51 | S 59 E | 14 | | | |
| 12 | N 71 30 E | 28 | 32 | N 70 E | 10 | 52 | S 16 E | 20 | | | |
| 13 | N 9 W | 24 | 33 | N 65 E | 18 | 53 | N 50 E | 0 | | | |

Wafford County to Wit

We Murray Forbes and Thomas Seddon

Justices of the Peace in the County aforesaid in the State of Virginia do hereby Certify that Elizabeth W. Dade the wife of William A. G. Dade Parties to a certain Deed for the Conveyance of Real Estate to William French bearing date on the 11th day of May 1818 and hereunto annexed personally appeared before us in our County aforesaid and being examined by us privately and apart from her husband and having the Deed aforesaid fully explained to her she the said Elizabeth W. Dade acknowledged the same to be her act and Deed and declared that she had willingly signed sealed and delivered the same and that she wished not to retract it. Given under our hands & Seals this 11th day of May 1818.

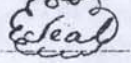
Murray Forbes 
 Thomas Seddon 

A Table of Courses & Distances

| No | Courses | Dist | No | Courses | Dist | No | Courses | Dist | No | Courses | Dist |
|----|-------------|------|----|-------------|------|----|----------|------|----|---------------|---------|
| *1 | S. 47. E | 15 | 21 | S. 72. E | 8 | 41 | S. 85. E | 20 | 61 | N. 51. E | 8 |
| 2 | S. 48. E | 18 | 22 | N. 65. E | 8 | 42 | N. 74. E | 12 | 62 | N. 66. E | 14 |
| 3 | S. 41. E | 10 | 23 | N. 33. E | 18 | 43 | N. 65. E | 24 | 63 | N. 61. E | 16 |
| 4 | S. 23. E | 24 | 24 | N. 40. E | 8 | 44 | S. 88. E | 13 | 64 | N. 57. E | 12 |
| 5 | S. 72. E | 8 | 25 | N. 59. E | 24 | 45 | S. 46. E | 14 | 65 | N. 27. E | 20 |
| 6 | N. 86. E | 72 | 26 | N. 43. E | 36 | 46 | N. 74. E | 9 | 66 | N. 22. E | 20 |
| 7 | N. 27. E | 19 | 27 | N. 35. E | 18 | 47 | N. 34. E | 20 | 67 | N. 32. E | 9 |
| 8 | S. 72. 30 E | 14 | 28 | N. 45. E | 12 | 48 | N. 58. E | 10 | 68 | N. 11. E | 30 |
| 9 | S. 58. E | 12 | 29 | N. 60. E | 8 | 49 | N. 84. E | 16 | 69 | N. 22. E | 11. 19 |
| 10 | N. 82. E | 20 | 30 | N. 87. E | 14 | 50 | N. 77. E | 10 | | * * * | |
| 11 | N. 75. E | 12 | 31 | S. 60. E | 33 | 51 | S. 59. E | 14 | 70 | N. 84. 25. N. | 166 1/2 |
| 12 | N. 71. 30 E | 28 | 32 | N. 70. E | 10 | 52 | S. 16. E | 20 | 71 | S. 1. 30. N. | 59 |
| 13 | N. 9. N | 24 | 33 | N. 65. E | 18 | 53 | N. 50. E | 9 | 72 | S. 85. 30 N. | 204 |
| 14 | N. 59. E | 14 | 34 | S. 67. E | 29 | 54 | N. 39. E | 6 | 73 | S. 12. 30 N. | 114 |
| 15 | N. 72. E | 20 | 35 | N. 39. 30 E | 7 | 55 | N. 22. E | 12 | 74 | S. 17. 35 N. | 36 |
| 16 | N. 78. E | 18 | 36 | N. 37. N | 8 | 56 | N. 27. N | 17 | 75 | S. 6. 35 N. | 58 |
| 17 | N. 46. 30 E | 23 | 37 | N. 49. N | 10 | 57 | N. 30. E | 8 | 76 | S. 16. 35 N. | 38 |
| 18 | S. 88. E | 12 | 38 | N. 14. N | 6 | 58 | N. 68. E | 23 | 77 | S. 8. 35 N. | 19 |
| 19 | S. 47. E | 8 | 39 | N. 37. E | 10 | 59 | N. 24. E | 12 | | * | |
| 20 | S. 30. E | 18 | 40 | N. 83. E | 20 | 60 | N. 56. E | 9 | | | |



Deeds of Wm. A. G. Dade & others
 beginning at a stone on the banks
 of the Cedar River & running to another stone
 in P. Alexander's land according to the
 above deeds
 21st Dec 1814

Wm. A. G. Dade
 Dec 21st 1814

at 520 250
 The dividing line between W. A. G. Dade & Mrs
 Funck beginning at a stone on the banks
 of the Cedar River & running to another stone
 in P. Alexander's land according to the
 above deeds

W. A. G. Dade
 Dec 21st 1814

59th Dec 1814



Scale of 50 paces for each
 variation of the bowlegs

Wm. A. G. Dade
 Dec 21st 1814
 Survey for the Hon. Judges
 Dade and the Sheriff, as the
 of land containing 976
 having and four and
 boundary marked and
 as the above may refer to
 John Shadwell, Jack
 Wm. A. G. Dade
 Dec 21st 1814

20
21
22
23
24
25
26
27
28
29
30
31
32
33
34
35
36
37
38
39
40
41
42
43
44
45
46
47
48
49
50
51
52
53
54
55
56
57
58

520 E 250

The dividing line between W. A. G. Dade & Wm French Beginning at a Stone on the Banks of the Cedar Run & running to another Stone in P. Abundances then according to the above Course

W. A. G. Dade
Dec 13 50

J. P. Abundance
Dec 15 50

St 9 W 200 fathoms

Scale of 50 fathoms for 1 inch
Alterations of this Course

Virginia
James Mill and Associates
October 11 1815
Surveyed for the Hon^{ble} Judges
Dade and the French a tract
of land containing 976 Acres
having used for one year and
possessing materials and articles
as the above map appears to
John Burdett Jack L. H. Cox
Surveyors

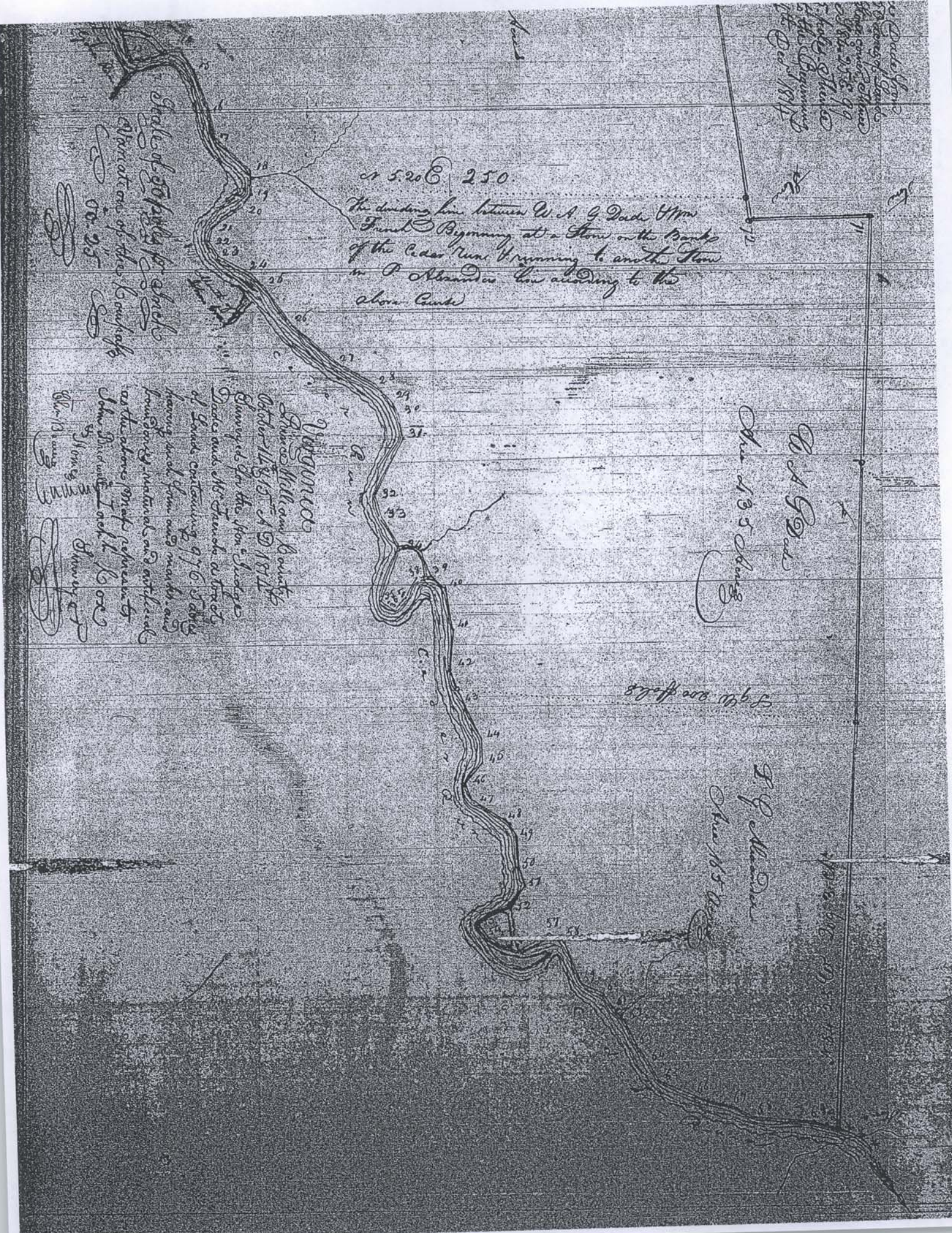
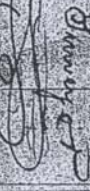
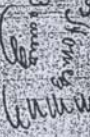
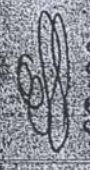

At a Court of Quarterly Sessions held for Prince William
County June 11th 1818. This Deed from William A. G. Dade and
Elizabeth W. his wife to William French with Certificates thereon
enclosed was presented to the Court and admitted to record.

Teste, Phil. T. Dams Clerk

Part
This Indenture made and entered into this
thirteenth day of May in the year one thousand eight hundred and
eighteen between Gustavus B. Tyler and Ann Hearty his wife and
William B. Tyler, Helen B. Tyler, Mary Ann Tyler, James M. Tyler
and Elizabeth B. Tyler infants through their guardian Sarah Tyler
of the one part and Allison Johnson of the other part the parties being
all of Prince William County State of Virginia Witnesseth: That
the said Gustavus B. Tyler and Ann Hearty his wife and W^m B. Tyler
Helen B. Tyler, Mary Ann Tyler, James M. Tyler and Elizabeth Tyler
through their said guardian Sarah Tyler for and in consideration of
the sum of Two hundred and Fifty dollars of lawful money of this
Commonwealth to them in hand paid (the receipt whereof is here-
by acknowledged) have bargained, sold and by these presents
do and each of them doth bargain and sell unto the said Allison
Johnson his heirs and assigns a certain house and lott in the town of
Dumfries being the same that was purchased by Charles Tyler dec^d
of Thomas Lee Sen. and Mildred Lee as may be seen by reference to the
deed bearing date the 10th December 1794 and duly recorded in the Clerks
Office of Prince William County, of which was in the division and
distribution of the Estate of the said Charles Tyler dec^d allotted
to the said Gustavus B. Tyler, W^m B. Tyler, Helen B. Tyler, Mary Ann
Tyler, James M. Tyler and Elizabeth Tyler Children & heirs of the said
Charles Tyler dec^d and bounded as per deed before referred to -
together with all & singular the appurtenances & thereto belonging
and the reversion and reversions remainder & remainders yearly and

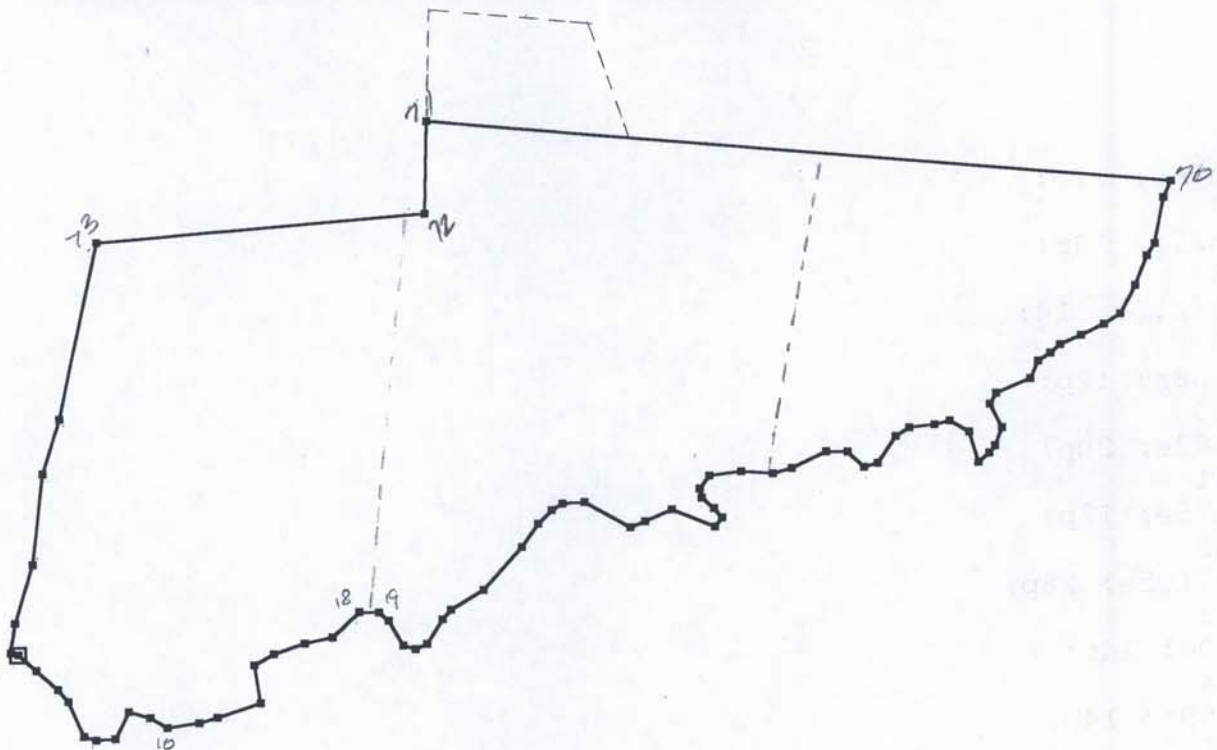

376.5
 435.0
 50.00
 105.
 1026.5

Edw. D. Fitzhugh to Dade 4350

Item 53
 !
 ! Abstracting info.
 Typ deed
 Id
 Ref P.W. DB 7, p.12
 Dat 25/11/1818
 Rec
 Frm William A. Dade
 To William French
 Con
 Re 976.5 acres
 Adj
 Wit

! Metes and bounds. "Beginning at..."
 Pt 1
 Ln s47e; 15p;
 Pt 2
 Ln s48e; 18p;
 pt 3
 ln s41.e; 10p;
 pt 4
 ln s23e; 24p;
 pt 5
 ln s72e; 8p;

pt 6
ln n86e; 12p;
pt 7
ln n27e; 19p;
pt 8
ln s72.5e; 14;
pt 9
ln s58e; 12p;
pt 10
ln n82e; 20p;
pt 11
ln n75e; 12p;
pt 12
ln n71.5e; 28p;
pt 13
ln n9w; 24p;
pt 14
ln n59e; 14p;
pt 15
ln n72e; 20p;
pt 16
ln n78e; 18p;
pt 17
ln n46.5e; 23p;
→pt 18
ln s88e; 12p;
pt 19
ln s47e; 8p;
pt 20
ln s30e; 18p;
pt 21
ln s72e; 8p;
pt 22
ln n65e; 8p;
pt 23
ln n33e; 18p;
pt 24
ln n40e; 8p;
pt 25
ln n59e; 24p;
pt 26
ln n43e; 36p;
pt 27
ln n35e; 18p;
pt 28
ln n45e; 12p;
pt 29
ln n60e; 8p;
pt 30
ln n87e; 14p;
pt 31
ln s60e; 33p;
pt 32

ln n70e; 10p;
pt 33
ln n65e; 18p;
pt 34
ln s67e; 29p;
pt 35
ln n39.5e; 7p;
pt 36
ln n37w; 8p;
pt 37
ln n49w; 10p;
pt 38
ln n14w; 6p;
pt 39
ln n37e; 10p;
pt 40
ln n83e; 20p;
pt 41
ln s85e; 20p;
pt 42
ln n74e; 12p;
pt 43
ln n65e; 24;
pt 44
ln s88e; 13p;
pt 45
ln s46e; 14p;
pt 46
ln n74e; 9p;
pt 47
ln n34e; 20p;
pt 48
ln n58e; 10p;
pt 49
ln n84e; 16p;
pt 50
ln n77e; 10p;
pt 51
ln s59e; 14p;
pt 52
ln s16e; 20p;
pt 53
ln n50e; 9p;
pt 54
ln n39e; 6p;
pt 55
ln n22e; 12p;
pt 56
ln n27w; 17p;
pt 57
ln n30e; 8p;
pt 58
ln n68e; 23p;

pt 59
ln n24e; 12p;
pt 60
ln n56e; 9p;
pt 61
ln n51e; 8p;
pt 62
ln n66e; 14p;
pt 63
ln n64e; 16p;
pt 64
ln n57e; 12p;
pt 65
ln n27e; 20p;
pt 66
ln n22e; 20p;
pt 67
ln n32e; 9p;
pt 68
ln n11e; 30p;
pt 69
ln n22e; 11.19p;
pt 70
ln n84.417w; 464.5p;
pt 71
ln s1.5w; 59p;
pt 72
ln s85.5w; 204p;
pt 73
ln s12.5w; 114p;
pt 74
ln s17.58w; 36p;
pt 75
ln s6.58w; 58p;
pt 76
ln s16.58w; 38p;
pt 77
ln s8.58w; 19p;
end