

3-23

ODESCALCKI-GRAHAM H. 76-185

Joyce Odescalcki

76206 Lee Highway

754-7534

Gainesville, VA. 22065

room outside log
porch added c1890

farm or tenant house
log chinked w/ floors
rain + mud.

1/2 acre

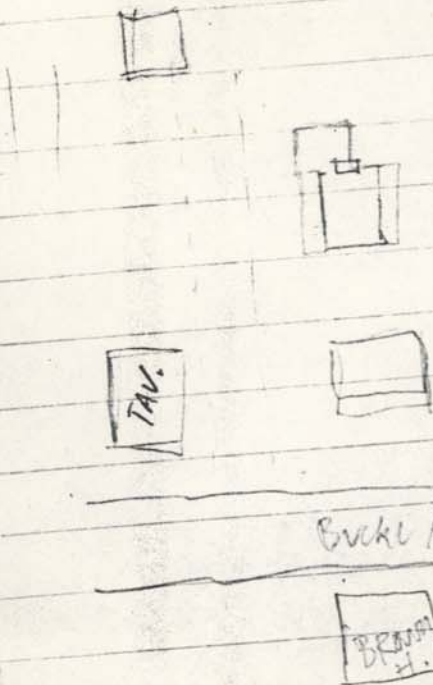

owner says
log section may go back
to late 1700s.

orig front door.

prev. owner

Jenkins family. AKA -
Old Graham House

"Ben" Graham

put on the addition
Mr. Fink's uncle lived
here.

XV

CRAWL SPACE UNDER PART OF HOUSE,
LOG JOISTS,
CRAWL SP. IN ATTIC.

MANTEL IN SHED REMOVED FROM
HOUSE IN 1960's.
2d MANTEL ALSO REMOVED FROM
HOUSE + LATER INSTALLED IN
MRS. FINK'S (TRONE) HOUSE - 1ST
FLOOR. UNABLE
UNABLE TO SEE MANTEL IN
SHED, SAID TO BE VERY PLAIN.

INTERIOR 1ST FLOOR OF LOG
SECTION PARTITIONED INTO 2 ROOMS.
FIREPLACE REMOVED FROM
SOUTH END OF LOG PORTION. SOME
CHIMNEY STILL IN ATTIC
concealed under roof.
F.P. IN addition 'BLOKED UP'

Replacement
dot.

double beards
beams.
width 9'

thick

panels

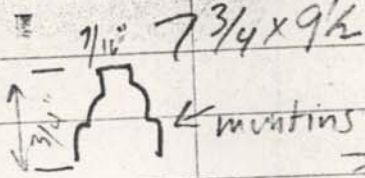

Keeping Room

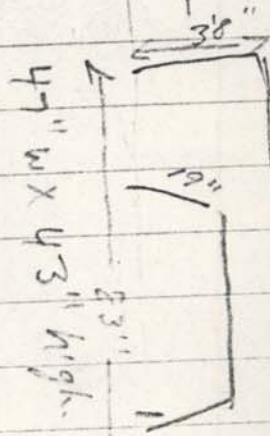

added
partition

metal is in place.

C/12 x 15

width have frame,
narrow by pine floor.

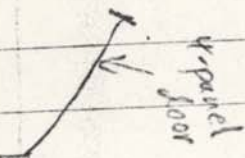

1/4 ash

Circular arch
with keystone. Partly rebuilt.

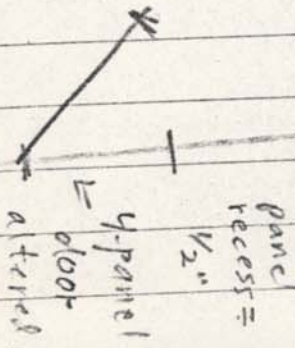

Mo. Fin. loc

hurd

former door - now a window

there is a chimney in attic above here.

68x15

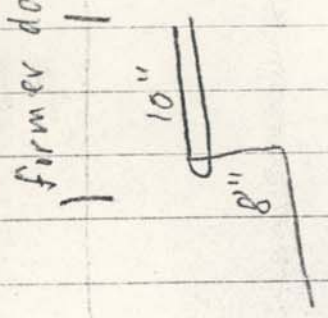

Bannister removed. may be around.

32 1/2" wide

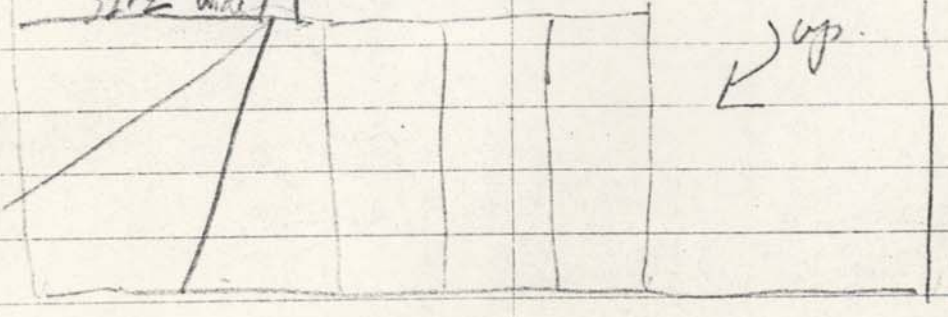

main door
door trim
R.D.R.
3 5/8

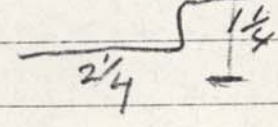

prob
at

19'3"

14'4"

MTK
11'8 1/2"
11'8 1/2"
4'5"
2'2"

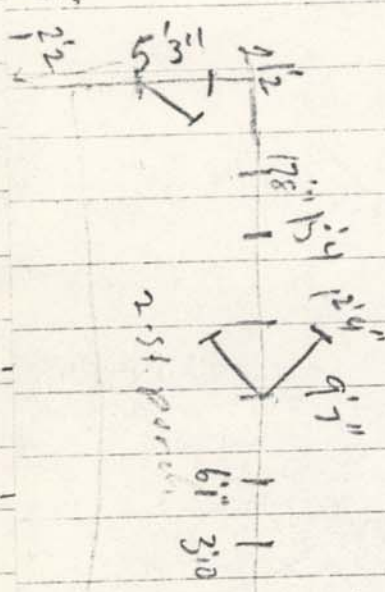

2nd. parson

28'4"

19'7" 17'4"

Top measured

5" lap
shaped cedar
shingles in
E gable end of A

21'10"

DR. Kutfitt lived in Leitel's house

DR. BROWN'S House was a hospital during Civil War
Village green across from Buckland Hall a hanging there?

Rumor of a chest of silver hidden. Rumor came
from the Campbells.

Miss Emma Macintosh ⁷ MacIntyre.

girl friend of Mrs. Finks.

lived in house taken by the road c1952.?

MacIntosh's were wool dyers.

Miss Emma was a seamstress, made a
dress Joyce has.

married Wally Sanders.

went to school at
The Pines
before - 12 yrs older
than Mrs F.

Miss Emma lived in Tavern w/ Mrs. Bear, or
before Mrs. Bear. Struck by a car in D.C.
died in 1949.

Sabazette's aunt - came by tavern, stood on
balcony - poems + flowers.

1979
90

G.W. visited the tavern.

MRS. F. b.
1889.
19

Caste visited her

Wm Sherman.

lived in Fauquier
county.

~~Mrs. Bear.~~

~~Lunsford's owned + oper. genl store above Buckland.~~

~~Joe Campbell lived in Dr. Brown House
for about 10 years, before the Koches.~~