



VIRGINIA
HISTORIC LANDMARKS COMMISSION

File no. 76-166
Negative no(s). 5172

SURVEY FORM

Historic name	Pattie Cemetery	Common name	
County/Town/City	Prince William County		
Street address or route number	vic. S.R. 705 and S.R. 623		
USGS Quad	Gainesville	Date or period	
Original owner	Blackwells?	Architect/builder/craftsmen	
Original use			
Present owner	Higdon "Junior" Simpson	Source of name	
Present owner address	5831 Pageland Lane	Source of date	
	Gainesville, VA	Stories	N/A
Present use	Cemetery	Foundation and wall const'n	N/A
Acreage	c40' x 40'		

State condition of structure and environs Cemetery is in fair condition.

State potential threats to structure
Note any archaeological interest

Should be investigated for possible register potential? yes ____ no ____

Architectural description (Note significant features of plan, structural system and interior and exterior decoration, taking care to point out aspects not visible or clear from photographs. Explain nature and period of all alterations and additions. List any outbuildings and their approximate ages, cemeteries, etc.)

Located in a small, approximately 40-foot-square enclosure surrounded by a wire fence, the Pattie Cemetery is on the east side of S.R. 705, a few hundred yards southeast of the old Pattie House, a frame residence constructed in about 1900.

Interior inspected? N/A

Historical significance (Chain of title; individuals, families, events, etc., associated with the property.)

The old Pattie Cemetery may not be officially reserved in the recent deed transfer for the sale of the surrounding property by H.G. Simpson, the most recent owner.

The Pattie family after whom the cemetery is known came from Fredericksburg and owned farms in the western Prince William area during the mid-to-late 19th, and early into the 20th centuries.

There are about 15 burials in the small fenced enclosure. The earliest graves, those of the Blackwells, date to just after the Civil War and are marked with only fieldstones. Engraved markers exist for the Patties, however, including Benjamine F. (1818-1902), Luther B. (1851-1927), and Harriett R. (1860-1931).

The old Pattie House (c1900) is northwest of the cemetery.

Sources and bibliography
Published sources (Books, articles, etc., with bibliographic data.)

Primary sources (Manuscript documentary or graphic materials; give location.)

Names and addresses of persons interviewed E.R. Conner, III, Manassas Museum.

Plan (Indicate locations of rooms, doorways, windows, alterations, etc.)

Site plan (Locate and identify outbuildings, dependencies and significant topographical features.)

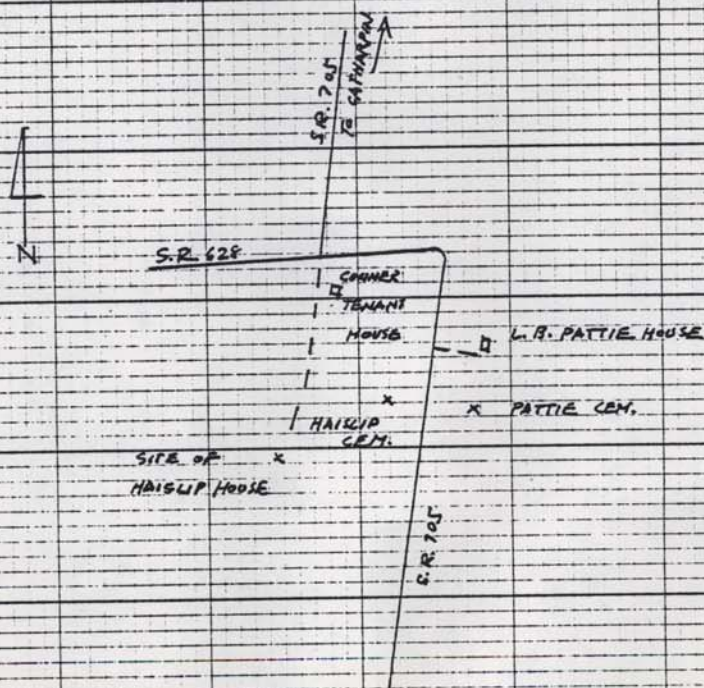

Name, address and title of recorder Frances Jones, Architectural
Historian - Surveyor, NHPDC

Date DEC 1980

