



VIRGINIA
HISTORIC LANDMARKS COMMISSION

File no. 76-105
Negative no(s). 4354

SURVEY FORM

Steno 3

Historic name Piedmont County/Town/City Prince William County Street address or route number vic. 3900 James Madison Highway USGS Quad Middleburg Original owner James Wormeley? Original use Residence Present owner Willie Properties, Inc Present owner address c/o James Long, Jr. 4824 Rugby Ave. Bethesda, Md. 20014 Present use Residence Acreage c400 acres (includes surrounding farmland).	Common name aka Wheatlands Date or period Late 18th C. Architect/builder/craftsmen Source of name Source of date Surveyor estimate. Stories 2;1 Foundation and wall const'n Stone foundation; frame wall construction. Roof type Metal-covered gable roof (wood shingles under metal).
State condition of structure and environs House in fair to good condition.	
State potential threats to structure Possible development, lack of maintenance. Note any archaeological interest	

Should be investigated for possible register potential? yes ___ no ___

Architectural description (Note significant features of plan, structural system and interior and exterior decoration, taking care to point out aspects not visible or clear from photographs. Explain nature and period of all alterations and additions. List any outbuildings and their approximate ages, cemeteries, etc.)

The house sits on a fenced yard c120' x 140'. Present tenant, Mrs. Blackburn, claims house once had a log kitchen wing, which was torn down and replaced with present 1-story kitchen. Mrs. Blackburn said present brick stove chimney on west end replaced a large stone chimney corresponding to that on the east end.

Siding is plain, 5"-lap weatherboard everywhere except on two-thirds of west side and kitchen e1, where it is channeled siding.

Painted white with green trim, but very weathered.

Room on 1st floor east (15½ x 19½) has 9½ foot ceilings, large fireplace (Federal? mantel), and concrete floor. Plain trim on windows, doors, ¾ round baseboard; 4-panel doors; and locks with brown glazed ceramic knobs. Windows 6/6.

Hall has a wide winding enclosed staircase with plain rail.

Upstairs rooms (2 separated by center hall) are of unequal height; room on west has floor c1' lower than hall and 8-foot ceilings.

Outbuildings include large 20th. century livestock barn, machinery barn, and various sheds.

Stone walk (once flanked by boxwood and trees) leads to front gate, about 50' from house.

Interior inspected?

Historical significance (Chain of title; individuals, families, events, etc., associated with the property.)

Miller & Long purchased the land (about 400 acres) from Homer S. Willie in 1964 and have been raising cattle there since then. The house and a small amount of land is rented to Mr. & Mrs. Cecil Blackburn. Miller and Long donated the land for the new Evergreen Fire Department, which is located close to the house.

The farm was owned by Frank Littleton in about 1930-1940. Littleton had purchased the 300 acres from Thomas Smith.

This property and Oakland (q.v.) across U.S. 15 (recently destroyed) were included in Lewis Burwell's portion of "King" Carter's Bull Run Tract. Ralph Wormeley purchased 1,400 acres here and left the land to his son, James Wormeley. James Wormeley gave part of what was to become the Piedmont estate to his daughter Ariana, who married William Neilson. The rest (Piedmont proper), James Wormeley willed to his son, Admiral Ralph Randolph Wormeley. Admiral Wormeley and his wife, Caroline, gave Piedmont to his nephew, George W. Norris, in 1851.

Sources and bibliography

Published sources (Books, articles, etc., with bibliographic data.)

Prince William, The Story of Its People and Its Places (1941, 1969), pp. 190-191.

Primary sources (Manuscript documentary or graphic materials; give location.)

Aerial photos (c1954), at Miller & Long offices

Historical photos (c1939), copies photographed from Mrs. Ruth Ballenger, across U.S. 15.

Names and addresses of persons interviewed Mrs. Cecil Blackburn, Tenant; Mr. James Long, Jr., President, Willie Properties, Inc. (See owner address).

Plan (Indicate locations of rooms, doorways, windows, alterations, etc.)

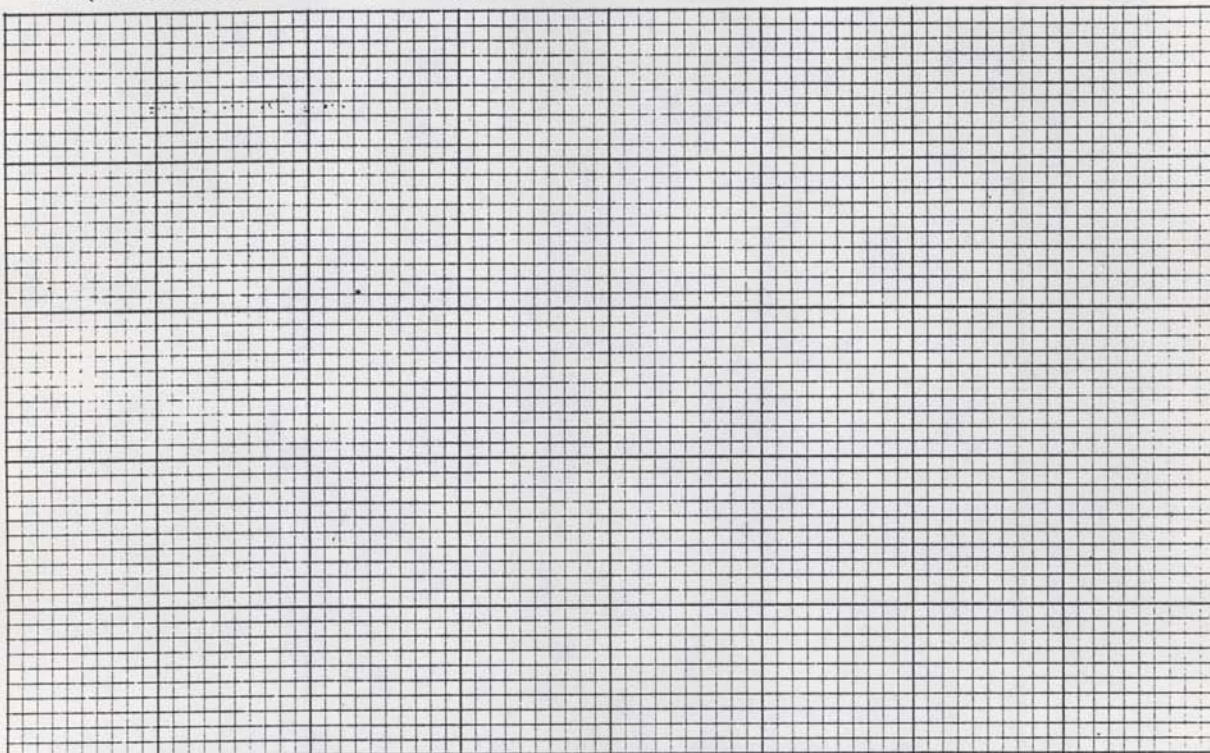

Site plan (Locate and identify outbuildings, dependencies and significant topographical features.)

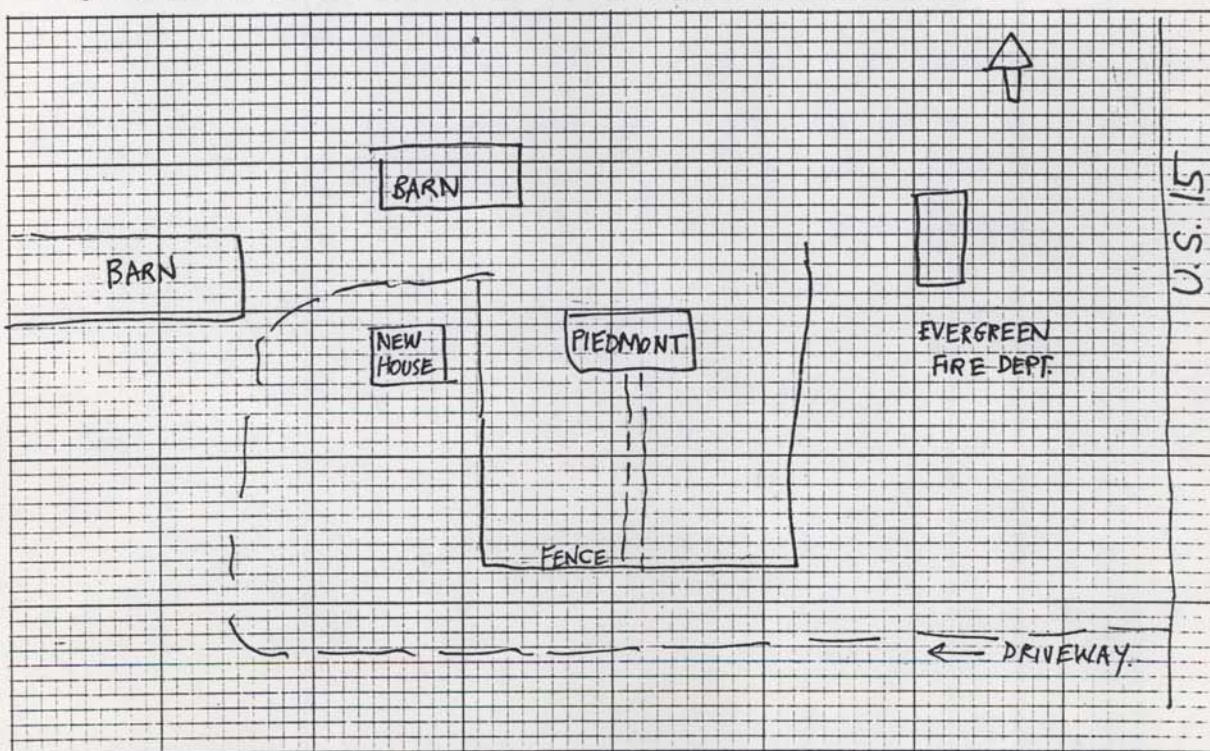

Name, address and title of recorder Frances Jones, Architectural Historian/Surveyor, NVPDC

Date 1/9/79

PIEDMONT (76-105), PRINCE WILLIAM COUNTY

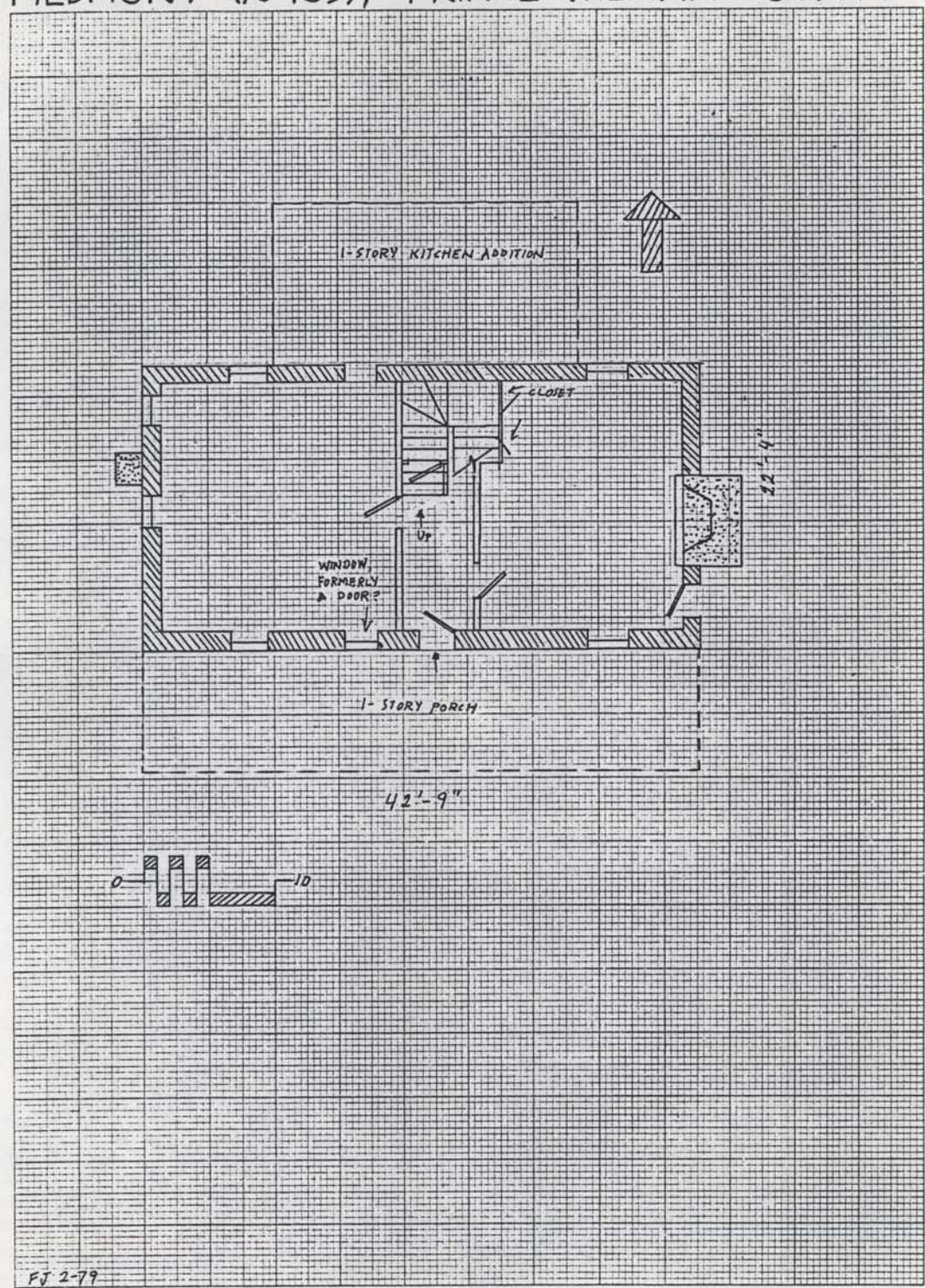

FJ 2-79